

## Ssang Yong Rodius 02/2014-

Partnr.: SY-009-BHU

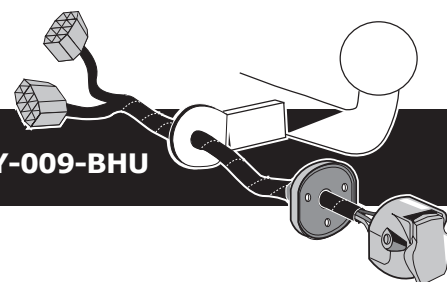

- Fitting instructions electric wiring kit tow bar with 12-N socket up to DIN/ISO Norm 1724.
- We would expressly point out that assembly not carried out properly by a competent installer will result in cancellation of any right to damage compensation, in particular those arising by virtue of the product liability act.
- Contents of these kits and their fitting manuals are subject to alteration without notice, please ensure that these instructions are read and fully understood before commencing installation.
- Do not overload circuits; the maximum loads per connection are detailed in this manual.
- Attention! Before Installation, please read this manual carefully and inform your customer to consult the vehicle owners manual to check for any vehicle modifications required before towing.
- In the event of functional problems, troubleshooting must be limited to about 0.5 hours, contact the technical support:  
[t.skinner@ecs-electronics.com](mailto:t.skinner@ecs-electronics.com) / 07440 202 052.



# Part list

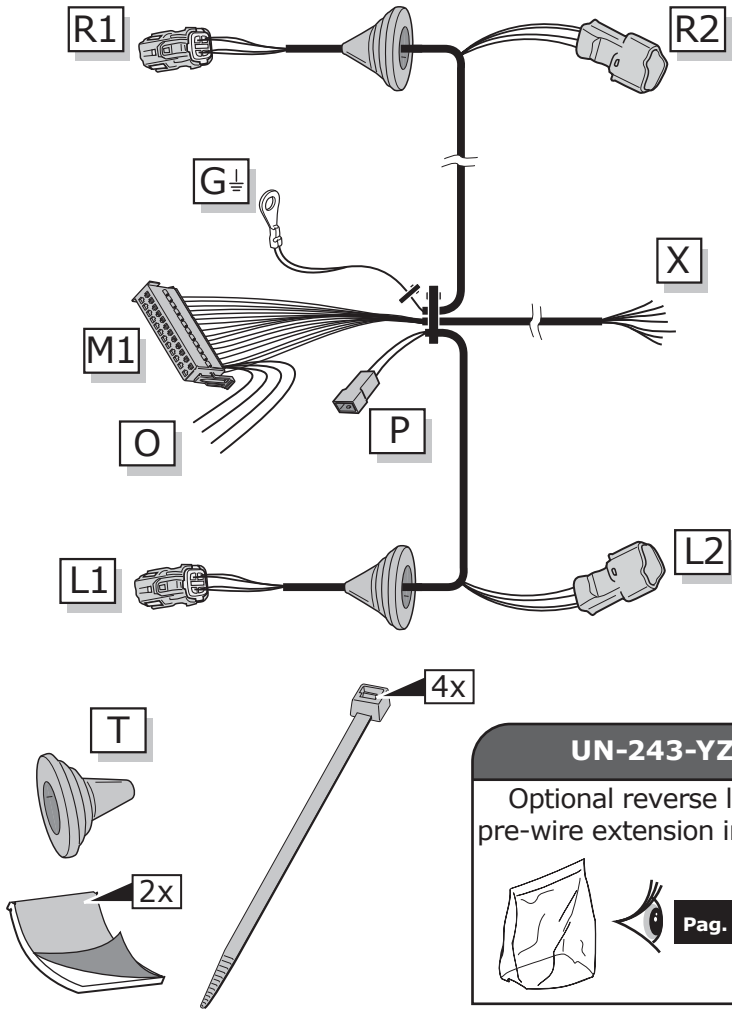
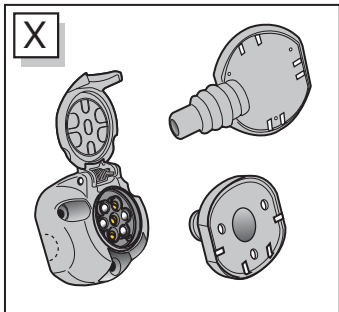
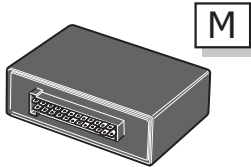
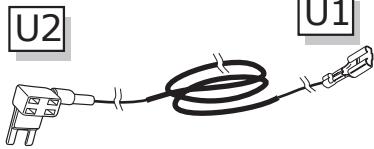
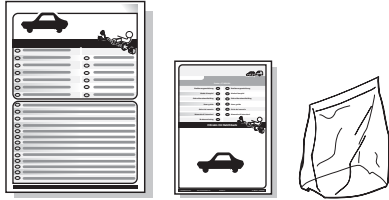
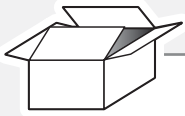

**UN-243-YZ**  
 Optional reverse lamp  
 pre-wire extension included

Pag. 13

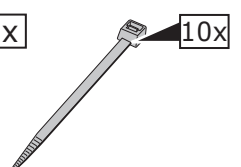
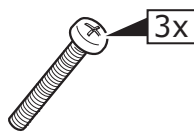
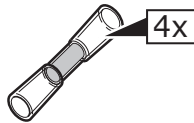
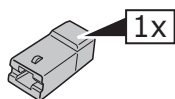
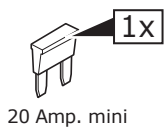

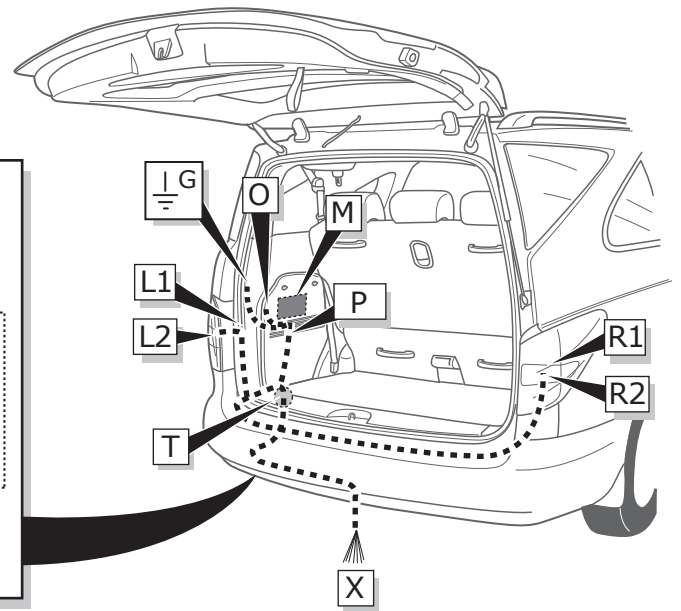
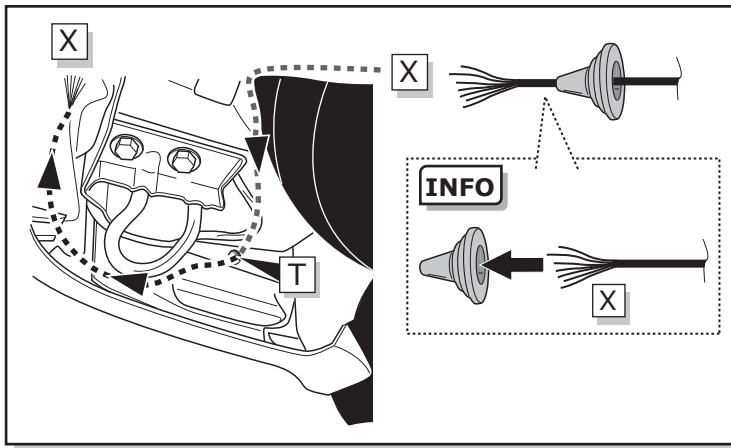
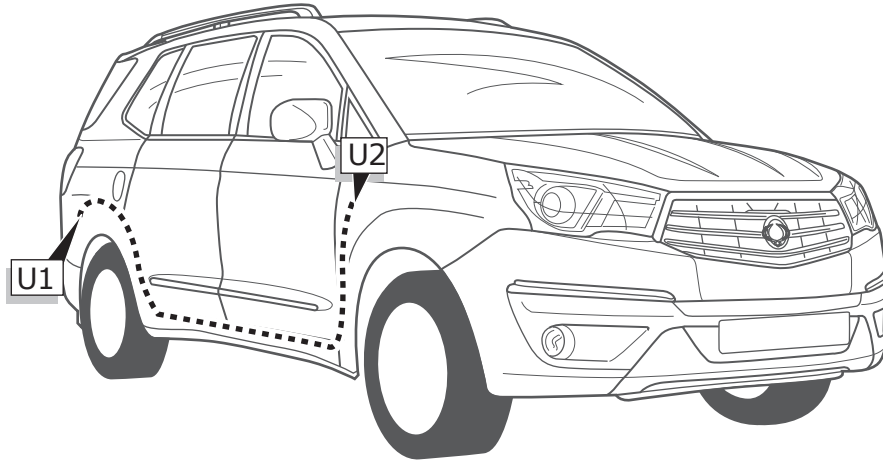

1

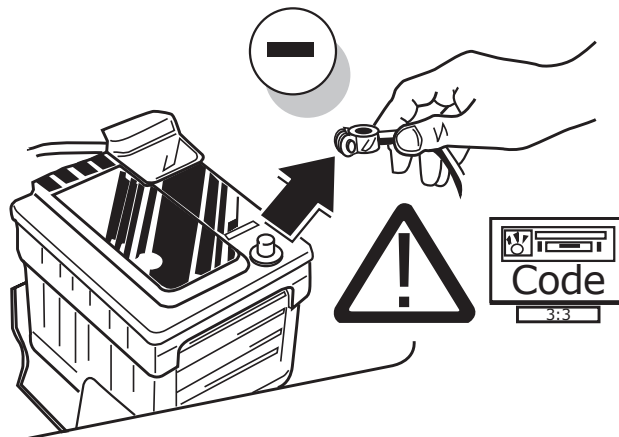

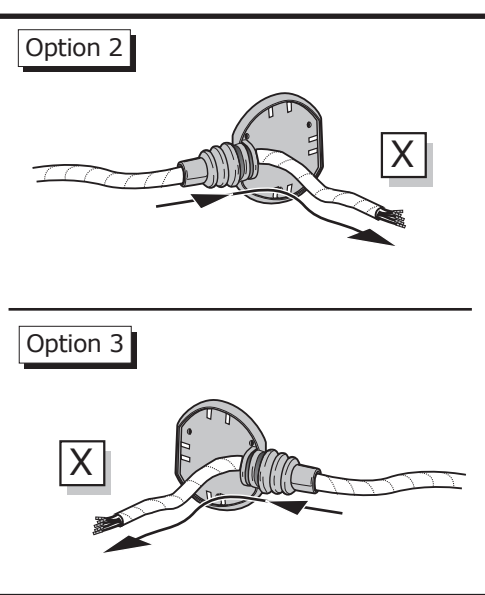
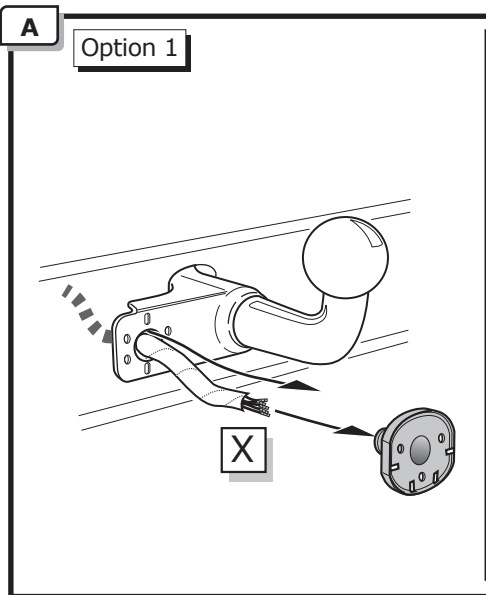
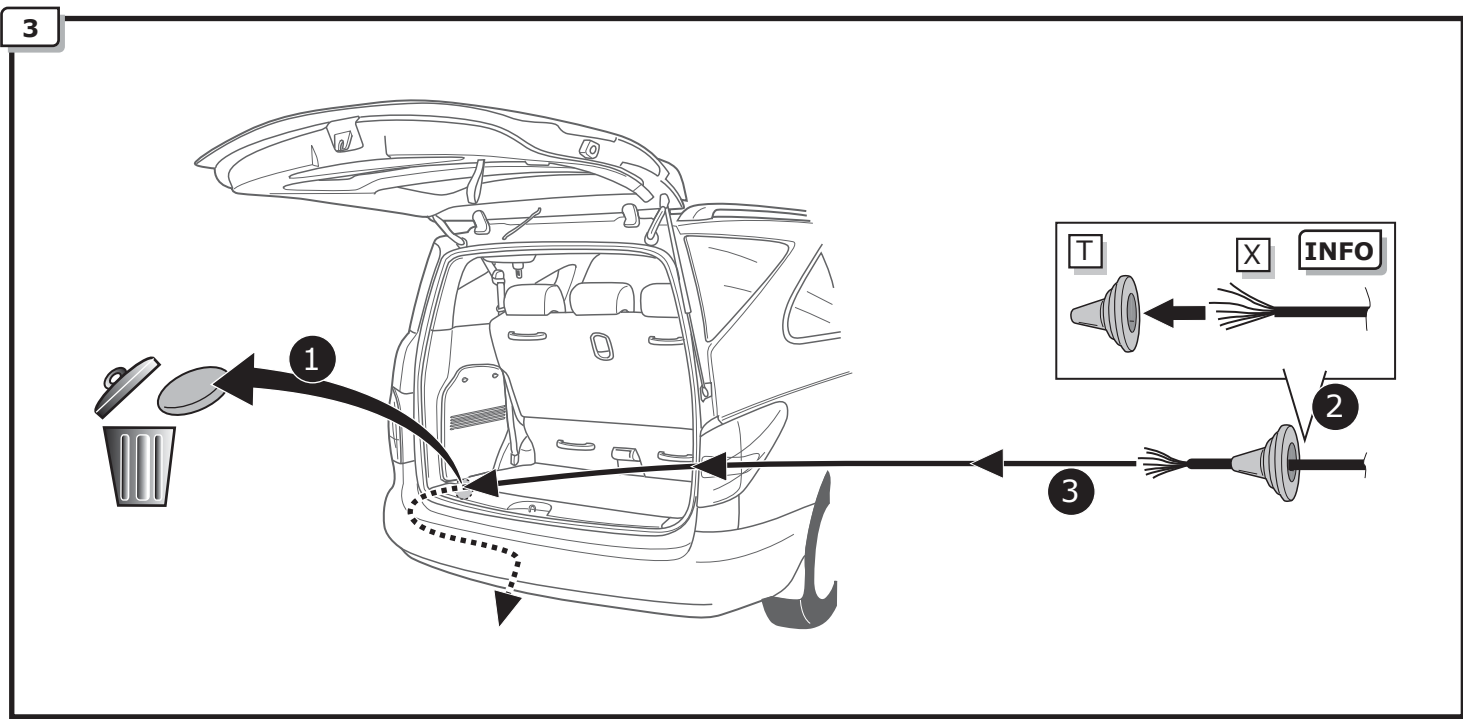
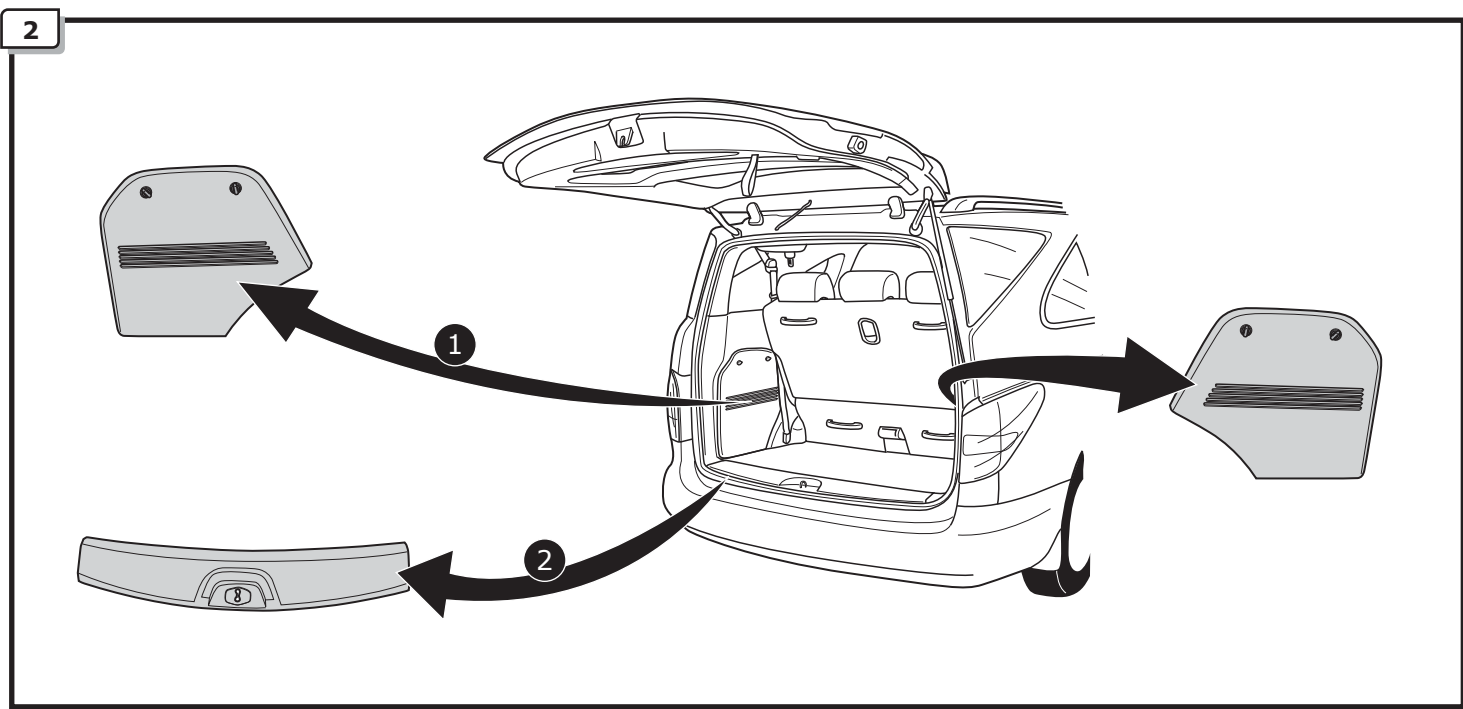

**INFO**

**SOCKET CONNECTION**

 **Pag. 12**

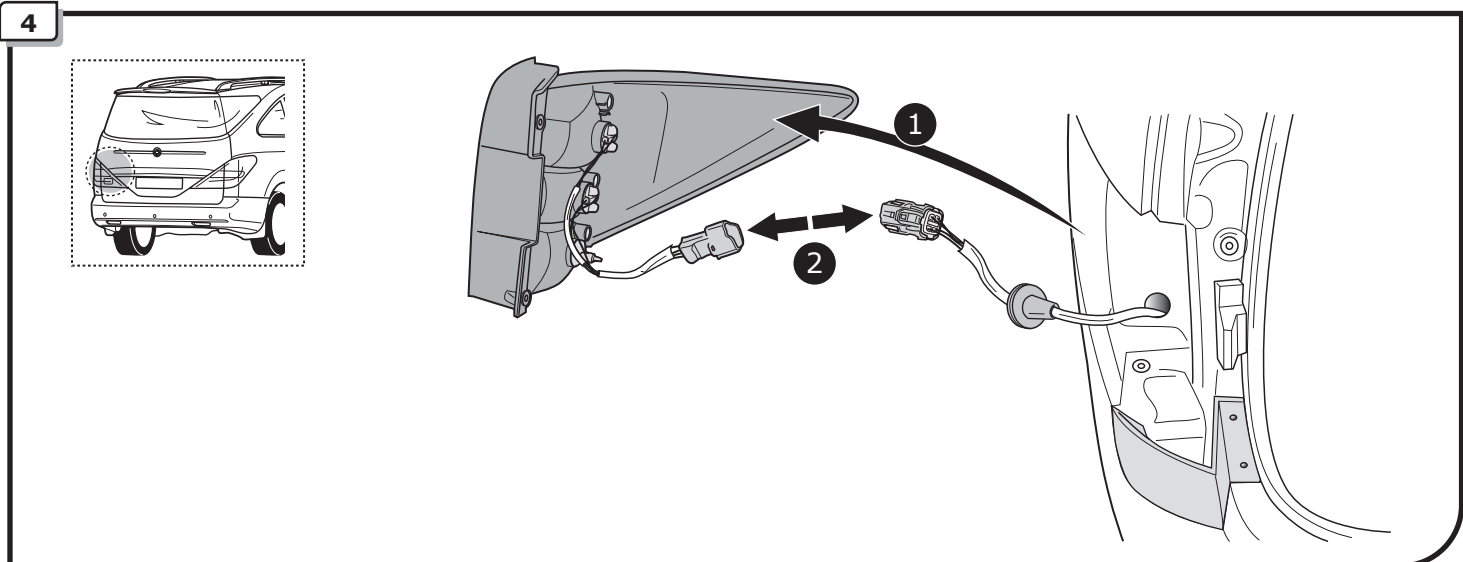
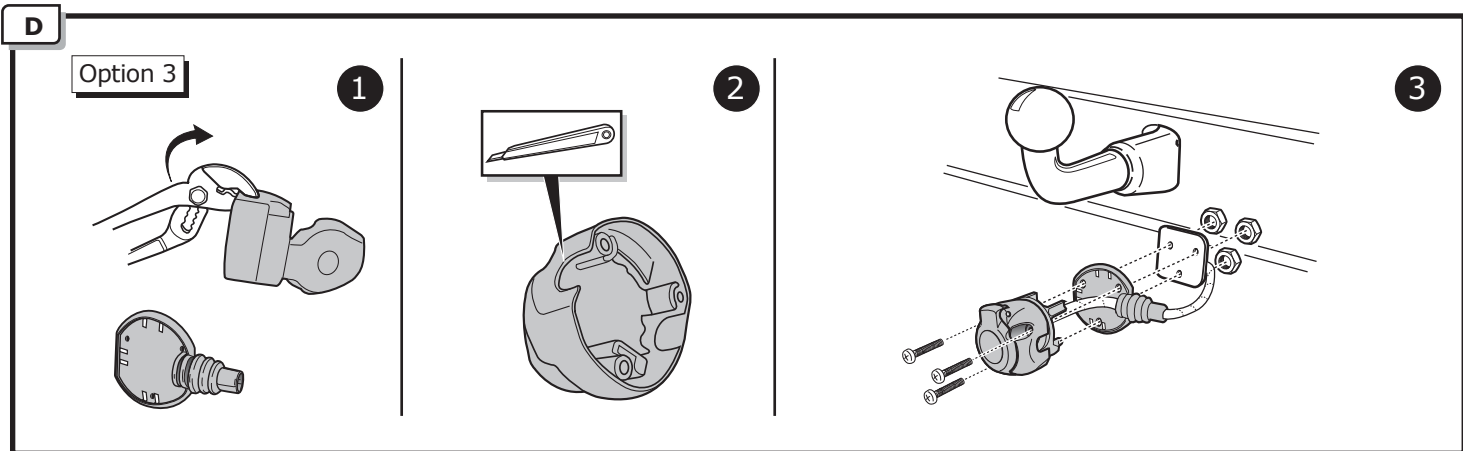
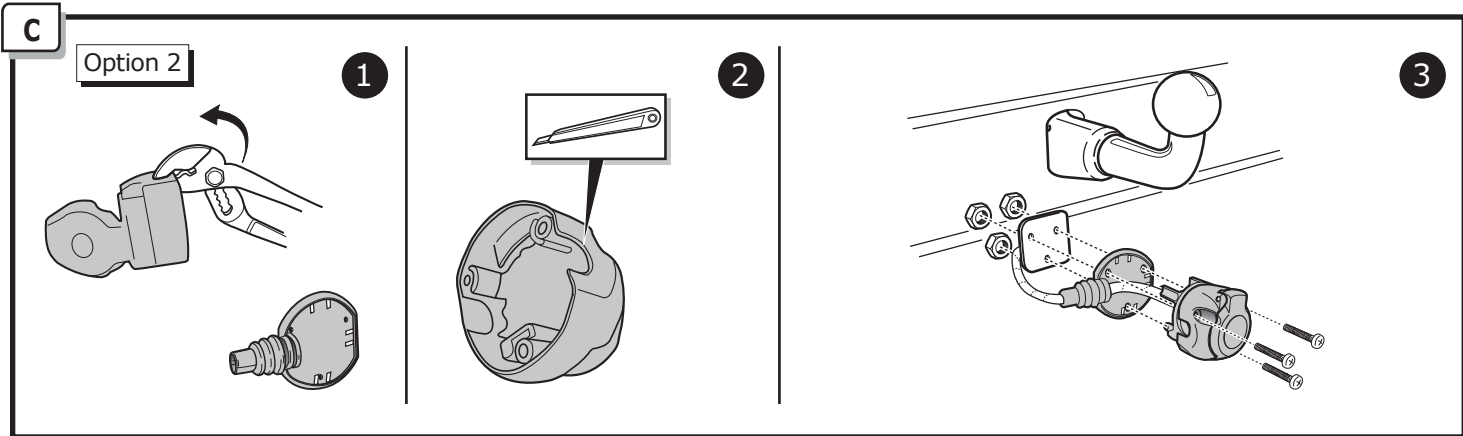
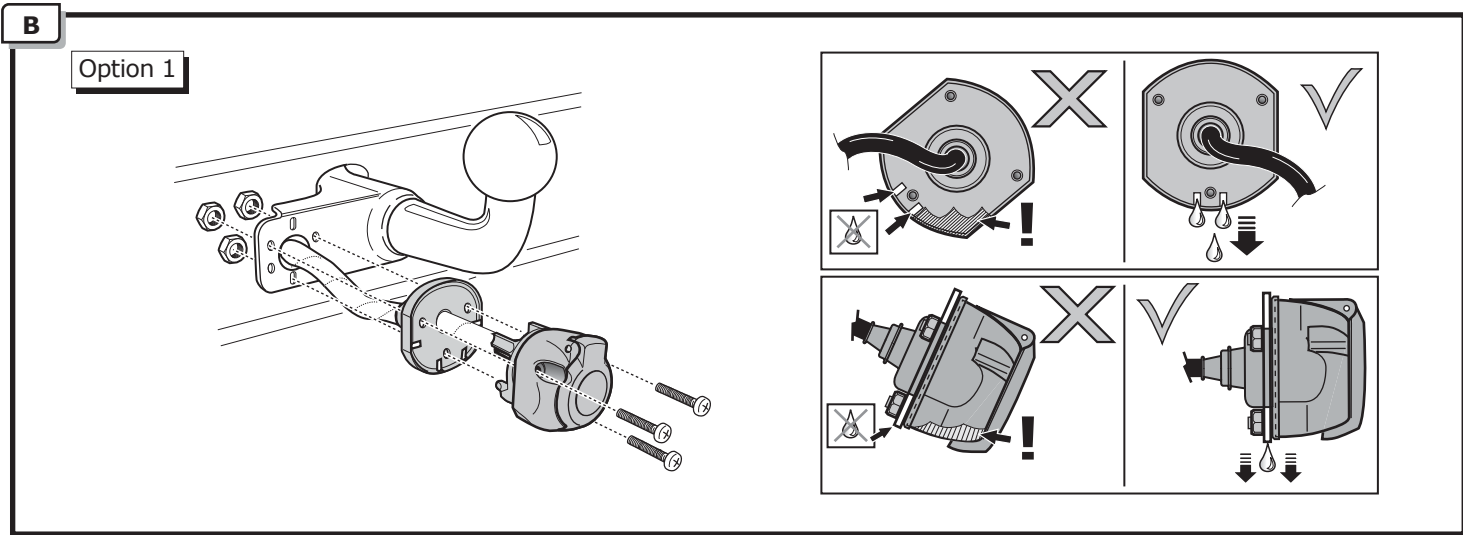

5

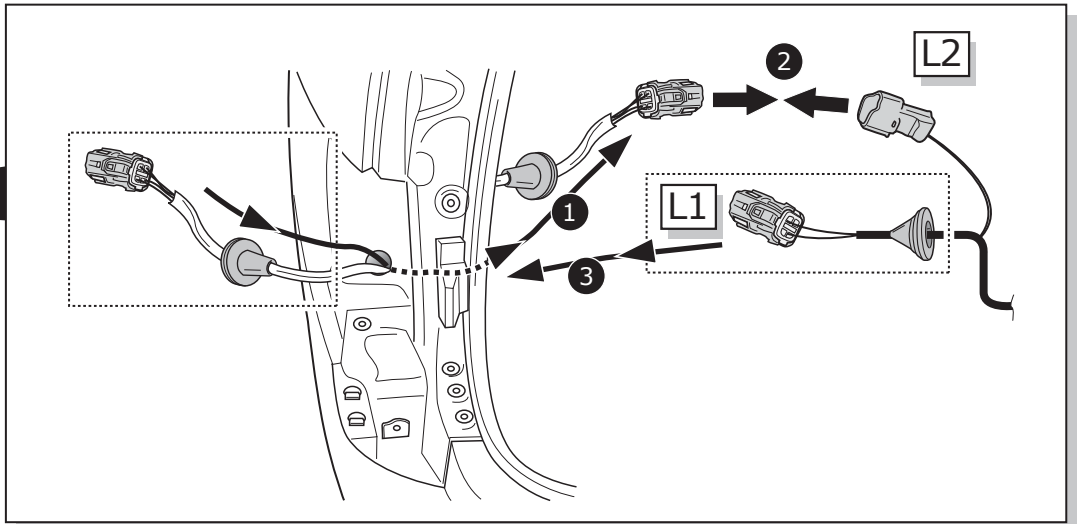
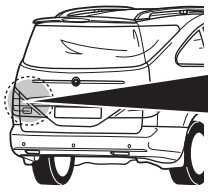

6

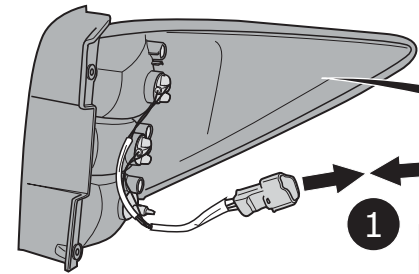

L1

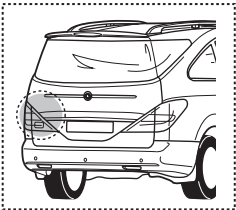
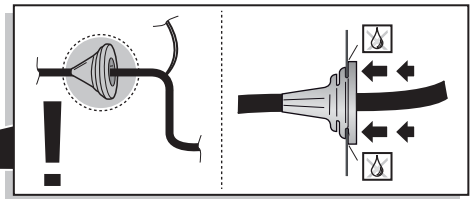

7

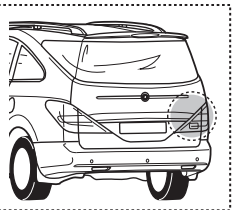
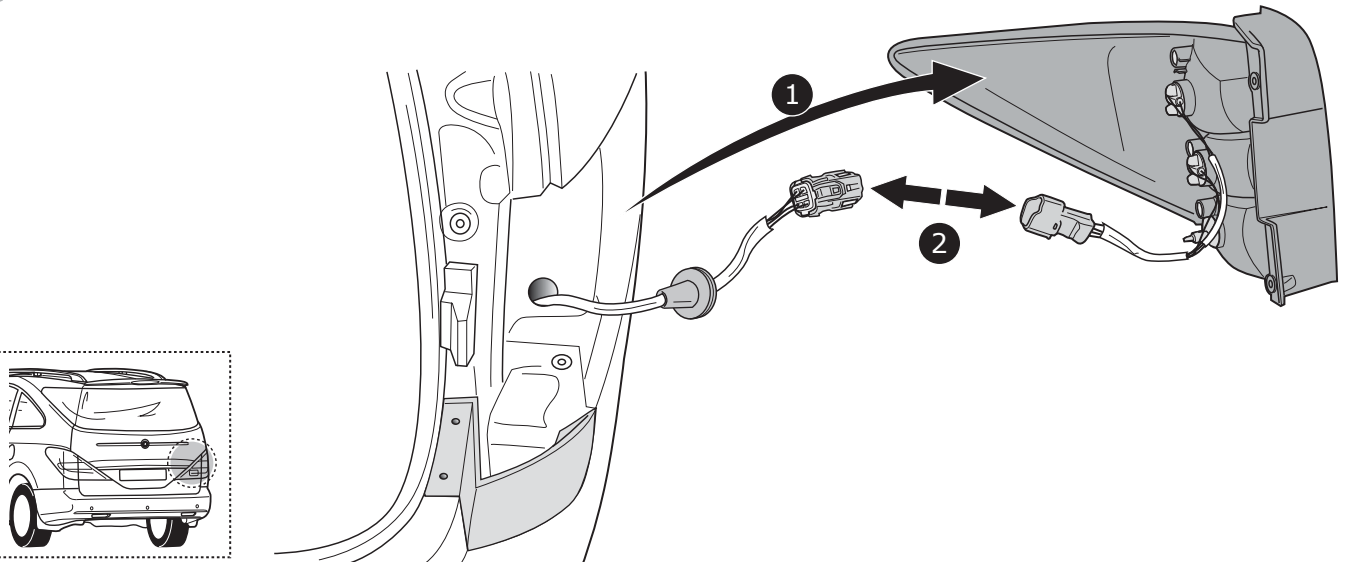

8

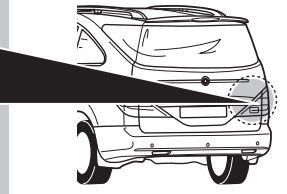
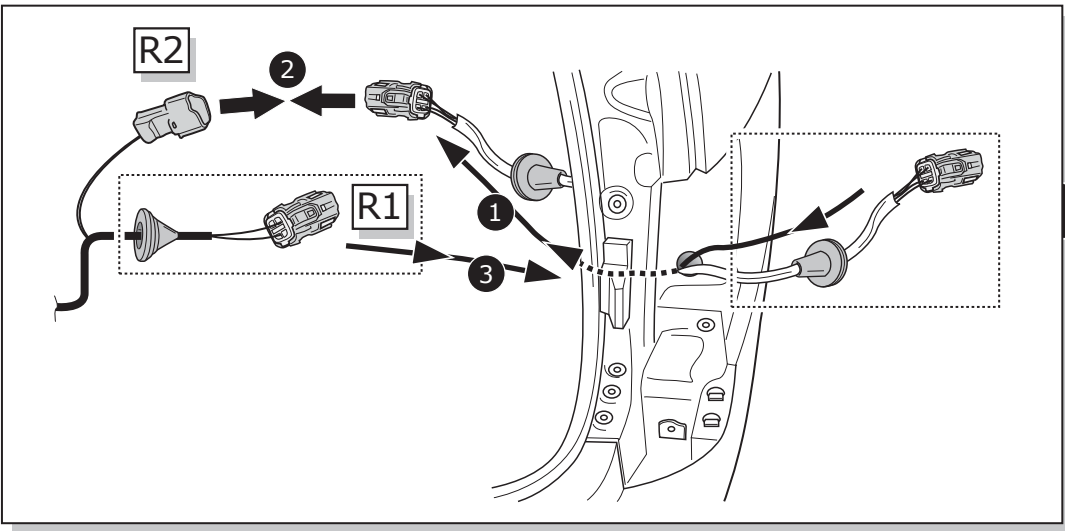

9

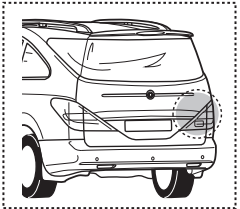
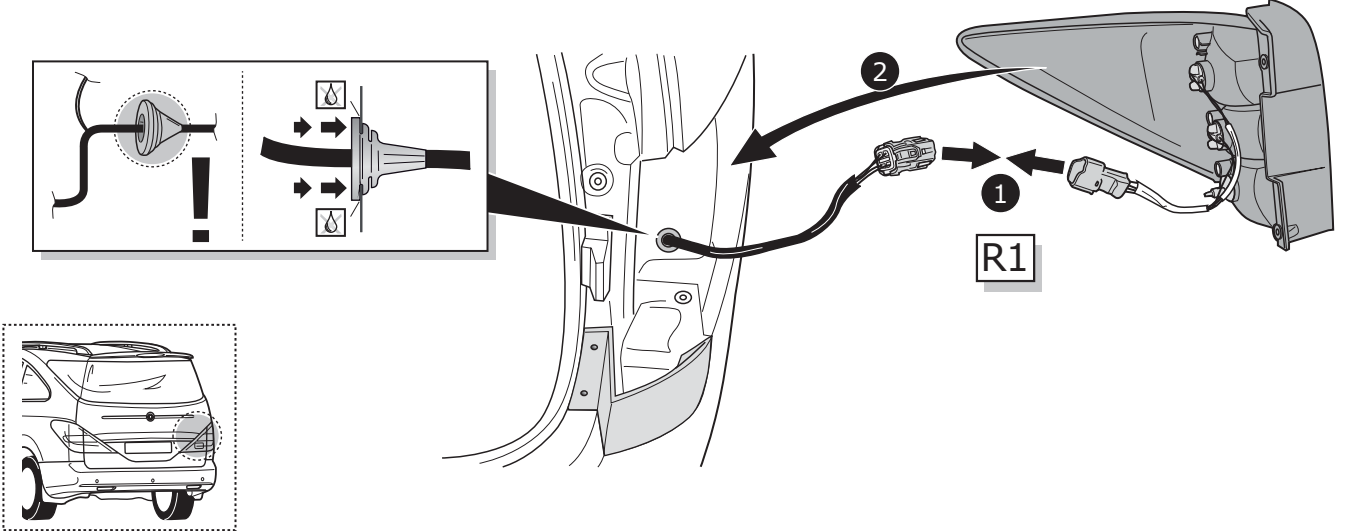

10

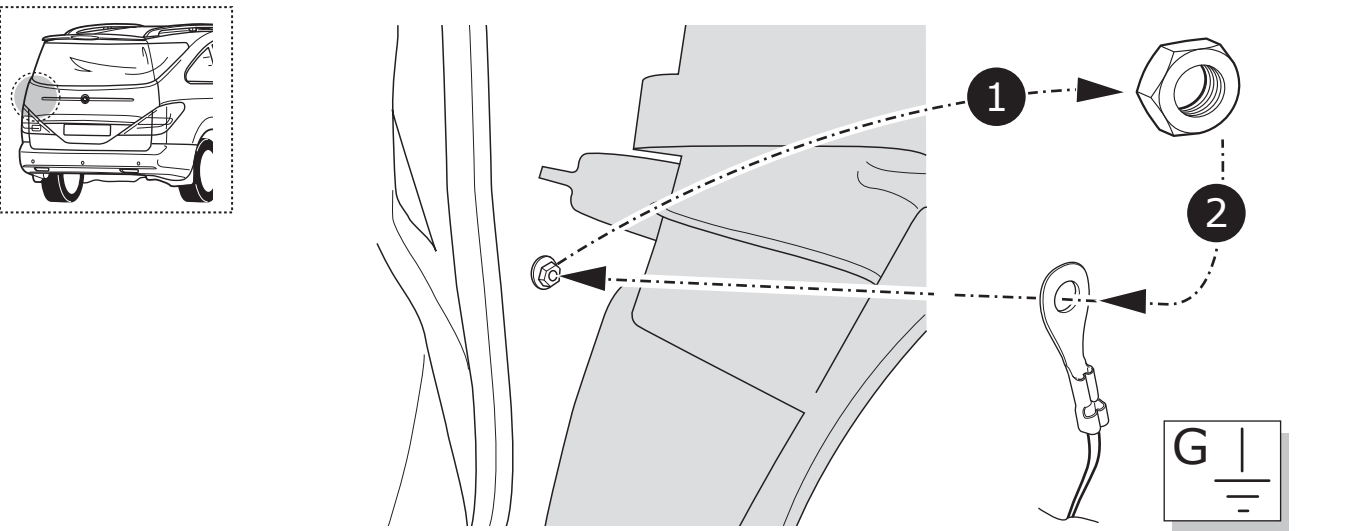

11

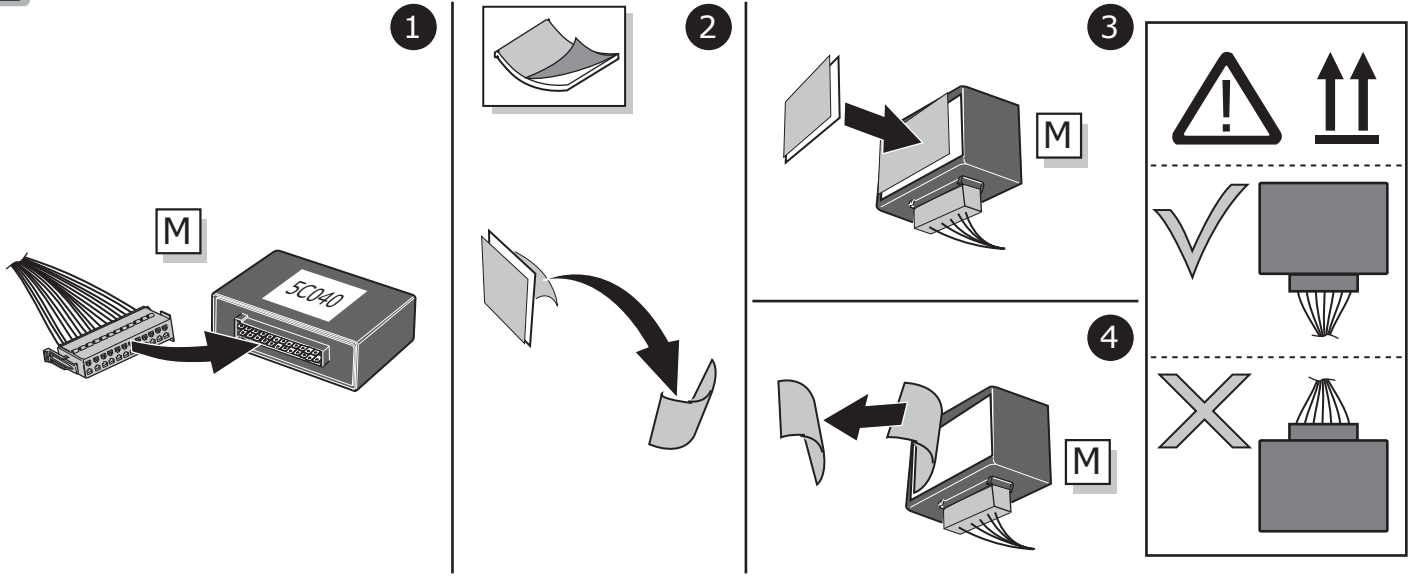

12

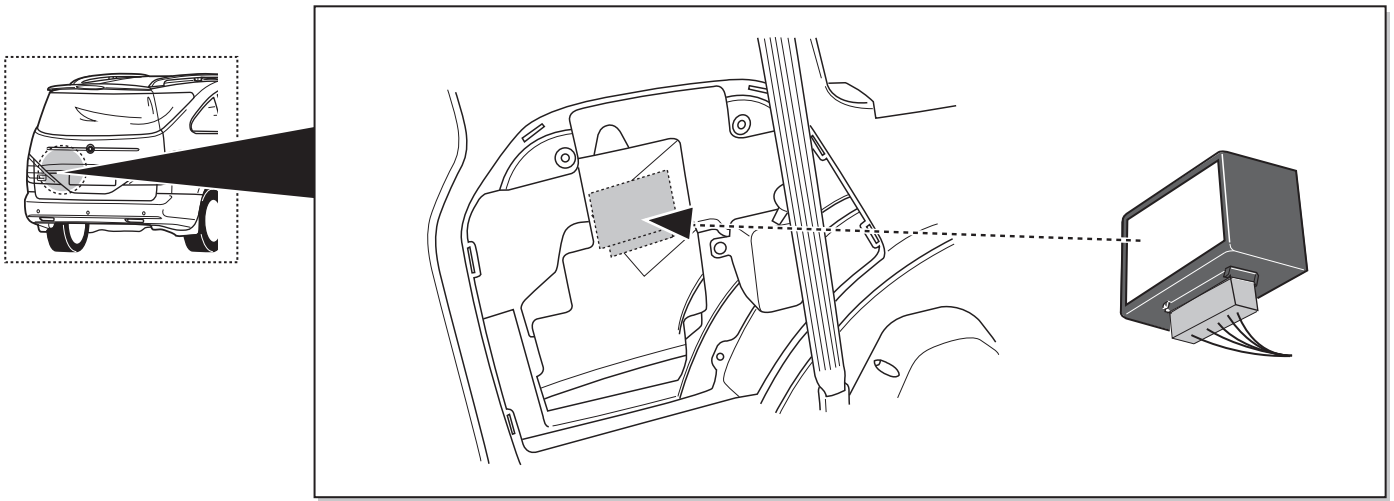

13

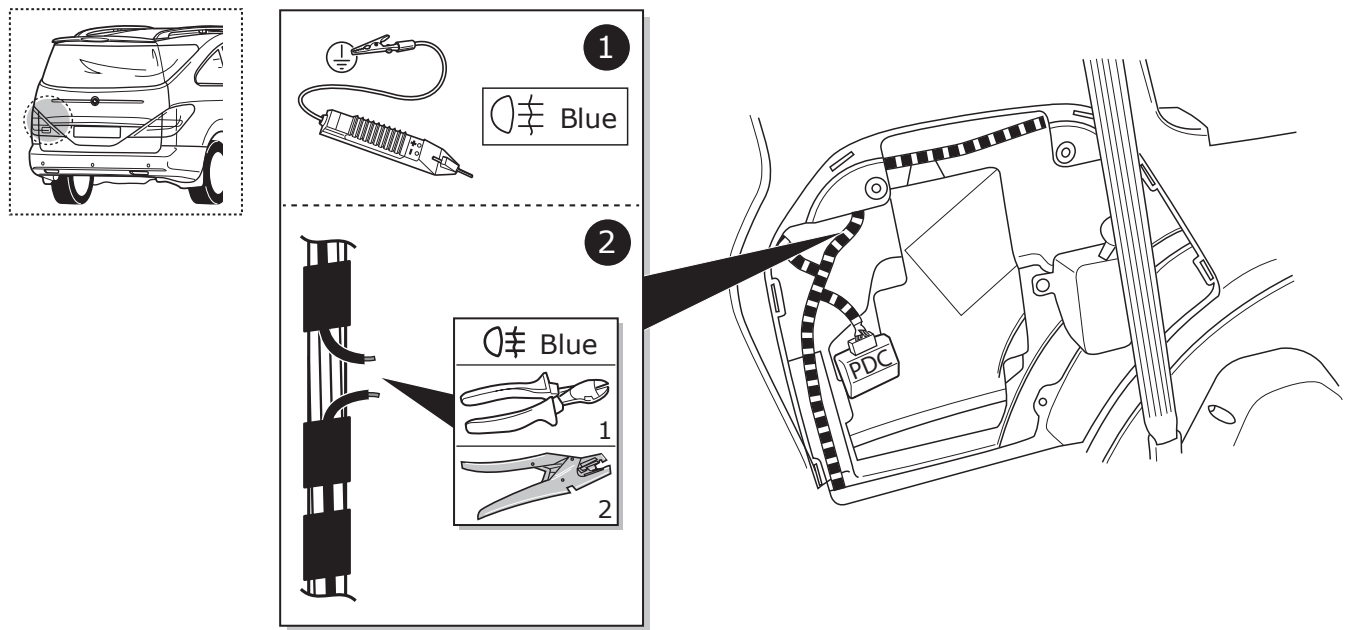



14

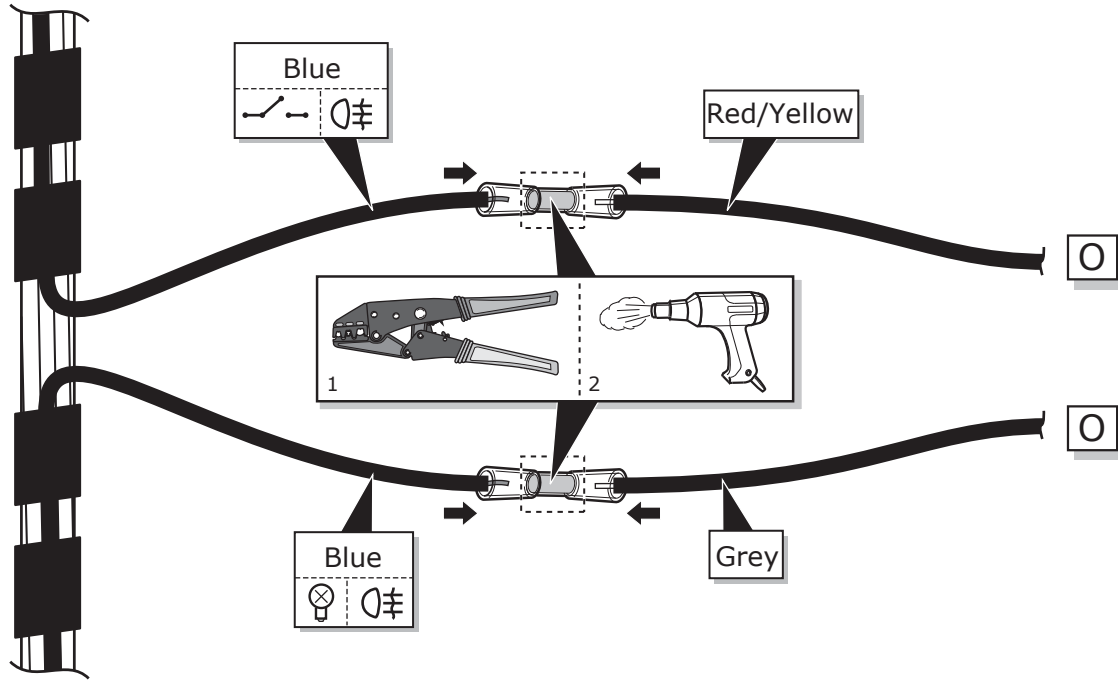

15

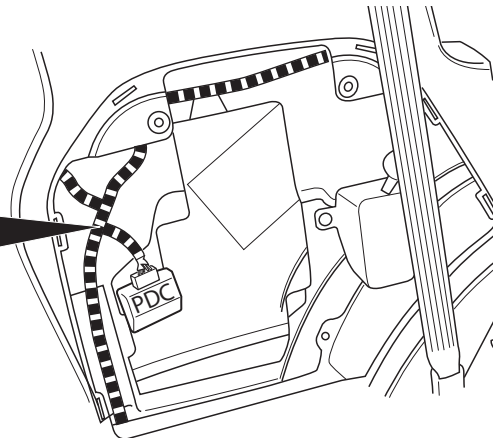
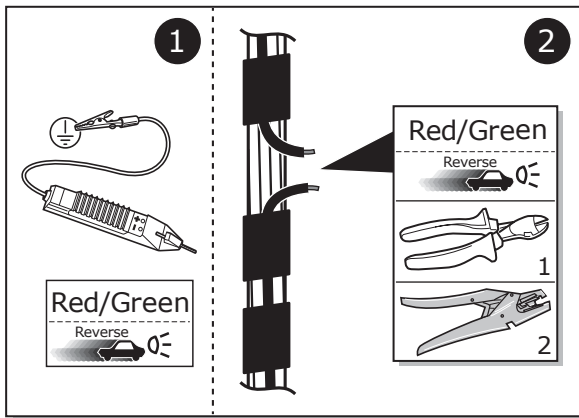
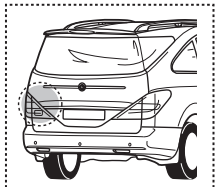

16

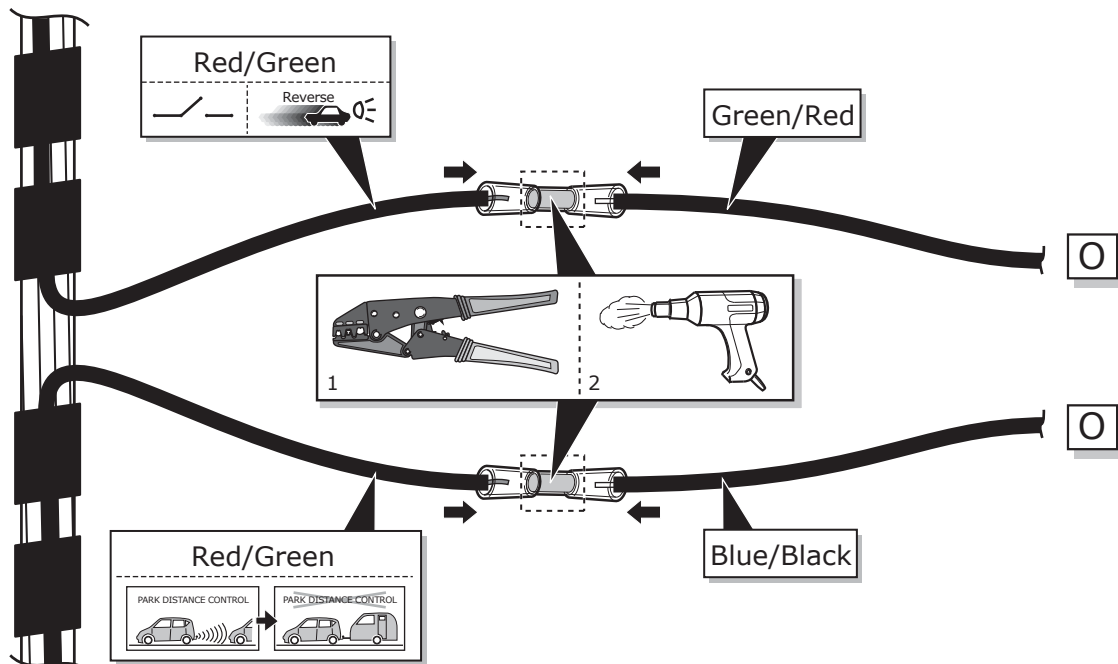

17

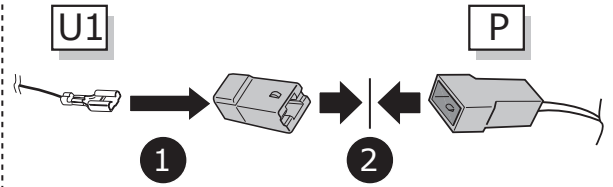
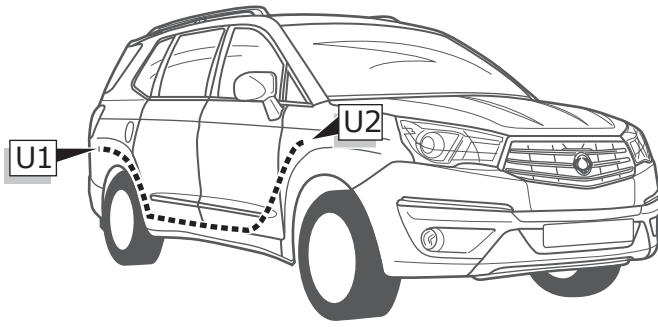

18

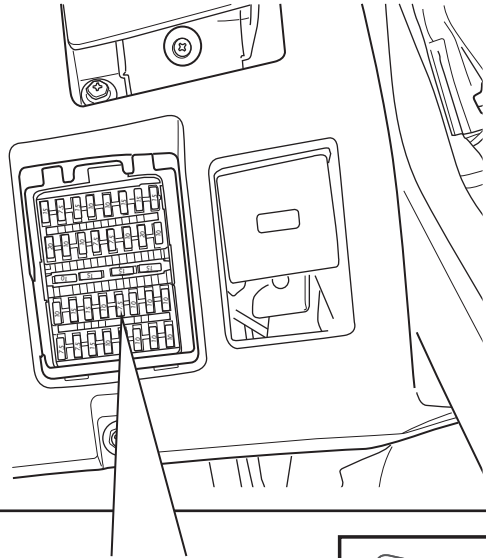
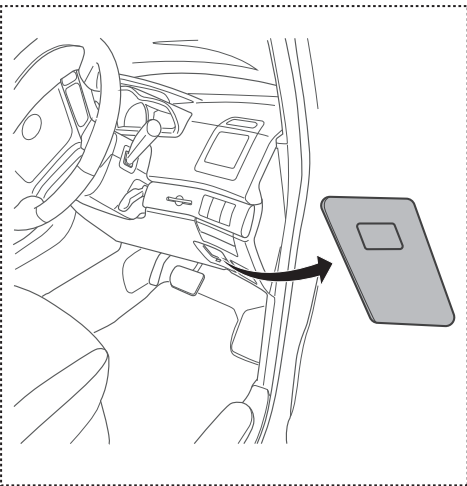

Option 1

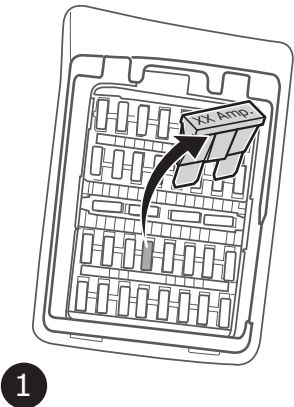

1

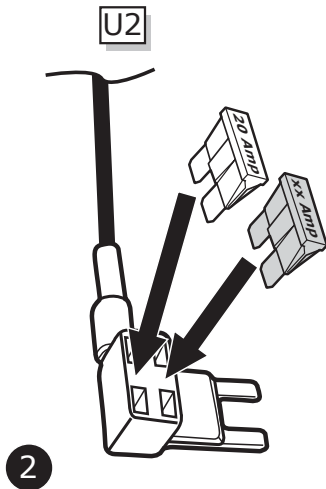

2

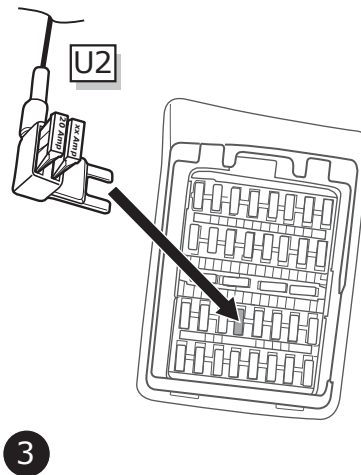

3

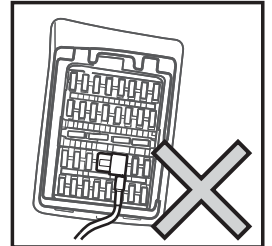
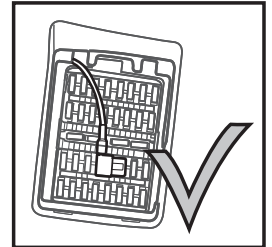

Option 2

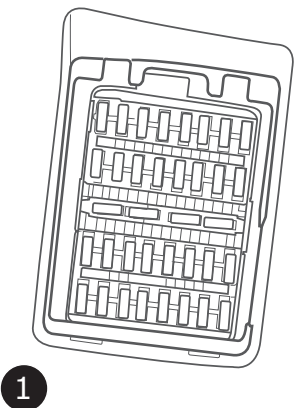

1

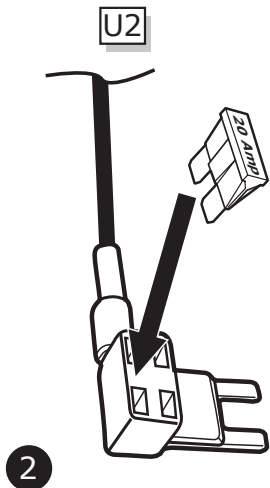

2

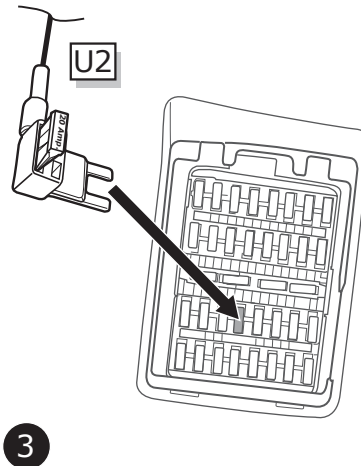

3

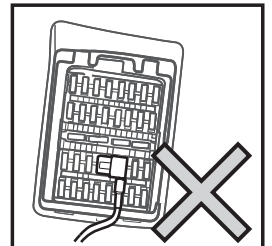
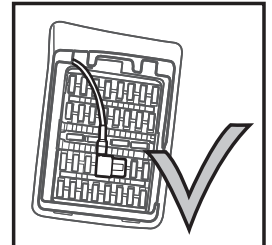

19

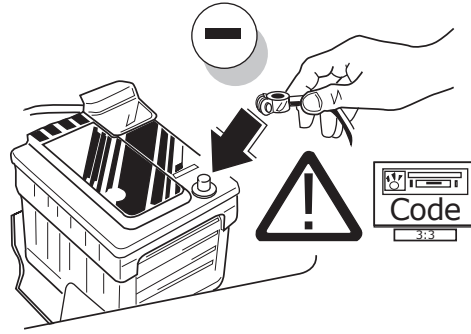

20

TEST ALL THE CIRCUITS WITH A TEST DEVICE WITH THE CORRECT POWER LOAD FOR EACH FUNCTION. A TEST DEVICE WITH LED'S CANNOT BE USED FOR THIS PURPOSE.

INFO





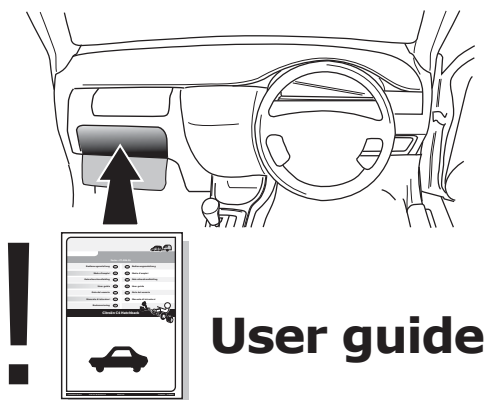

REINSTALL TRIM.

21

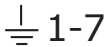

A technical support contact card for ECS Electronics. It features a headset icon with the text 'CALL 07440 202 052'. A diagonal banner says 'TECHNICAL SUPPORT'. At the bottom, it lists the company name 'ECS ELECTRONICS', the contact hours 'MONDAY TO FRIDAY 08.00 - 11.00 am 12.00 - 05.00 pm', and the email 't.skinner@ecs-electronics.com' and website 'www.ecs-electronicsuk.co.uk'.

SOCKET CONNECTION

DIN/ISO 1724							
	1/L	2	3/31	4/R	5/58-R	6/54	7/58-L
Pmax	21W	2x21W		21W	52W	3x21W	52W
Colour	Yellow	Blue	White	Green	Brown	Red	Black

# UN-243-YZ Reverse lamp pre-wire extension

⚠ MAX = 21W

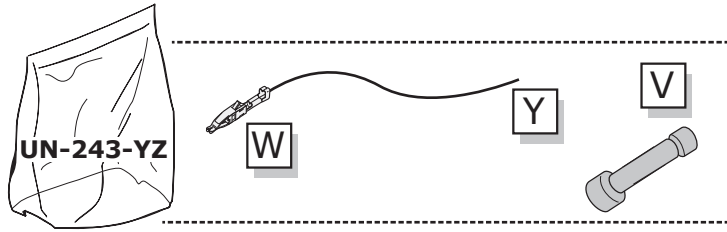

A

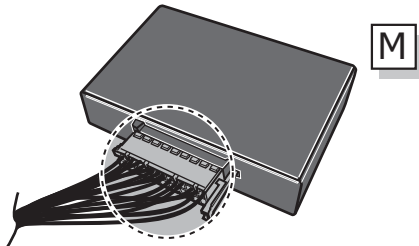

1

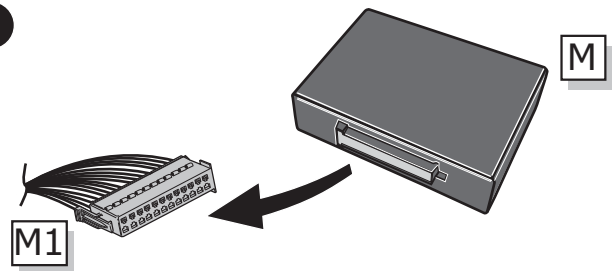

2

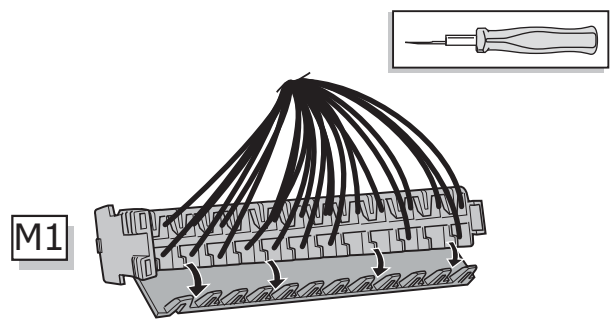

3

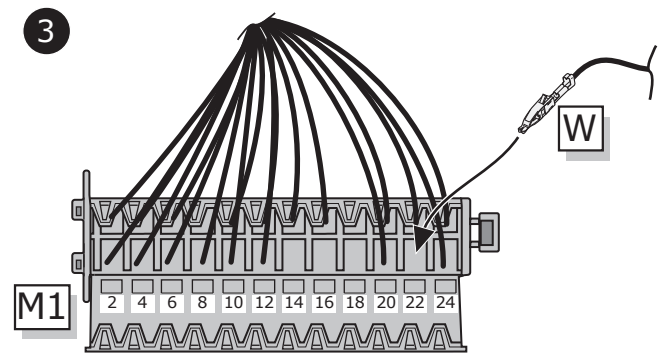

4

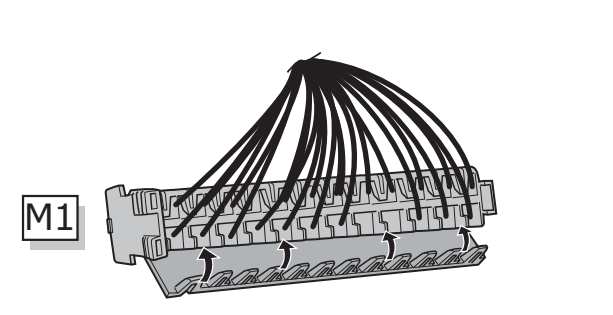

5

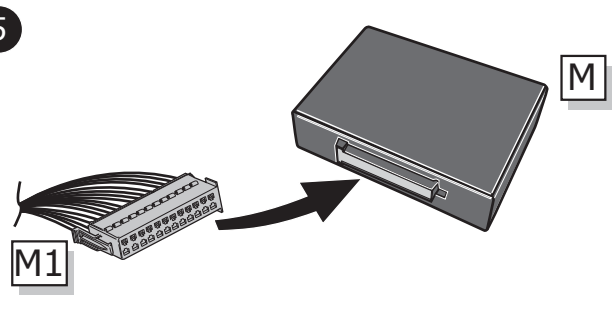

B

⚠ MAX = 21W

