

Citroën C5 10/2008- (Production Nr. 11679-)

Partnr.: CT-046-B1U

- Fitting instructions electric wiring kit tow bar with 12-N socket up to DIN/ISO Norm 1724.
- We would expressly point out that assembly not carried out properly by a competent installer will result in cancellation of any right to damage compensation, in particular those arising by virtue of the product liability act.
- Contents of these kits and their fitting manuals are subject to alteration without notice, please ensure that these instructions are read and fully understood before commencing installation.
- Do not overload circuits; the maximum loads per connection are detailed in this manual.
- Attention! Before Installation, please read this manual carefully and inform your customer to consult the vehicle owners manual to check for any vehicle modifications required before towing.
- In the event of functional problems, troubleshooting must be limited to about 0.5 hours, contact the technical support:
ukts@ecs-electronics.com / 07440 202 052.



Part list

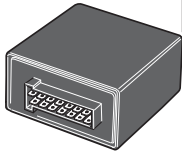
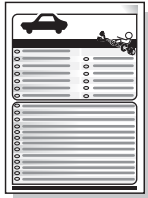
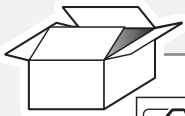

M

L2

M

U4

X

UN-243-YZ
 Optional reverse lamp
 pre-wire extension included

Pag. 11

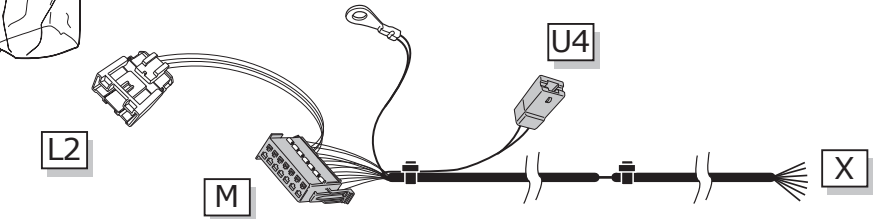

R1

U5

R1

R2

G

L1

3x

2x

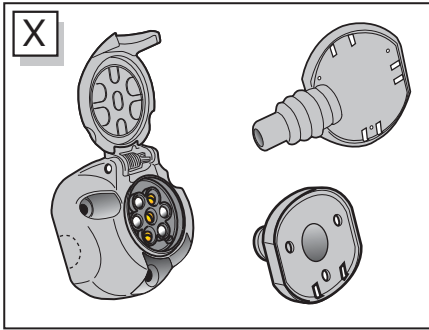

OPTION V6 HDI

8x

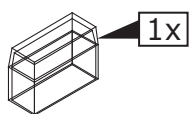
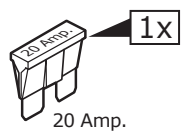
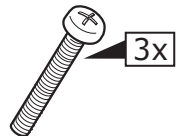

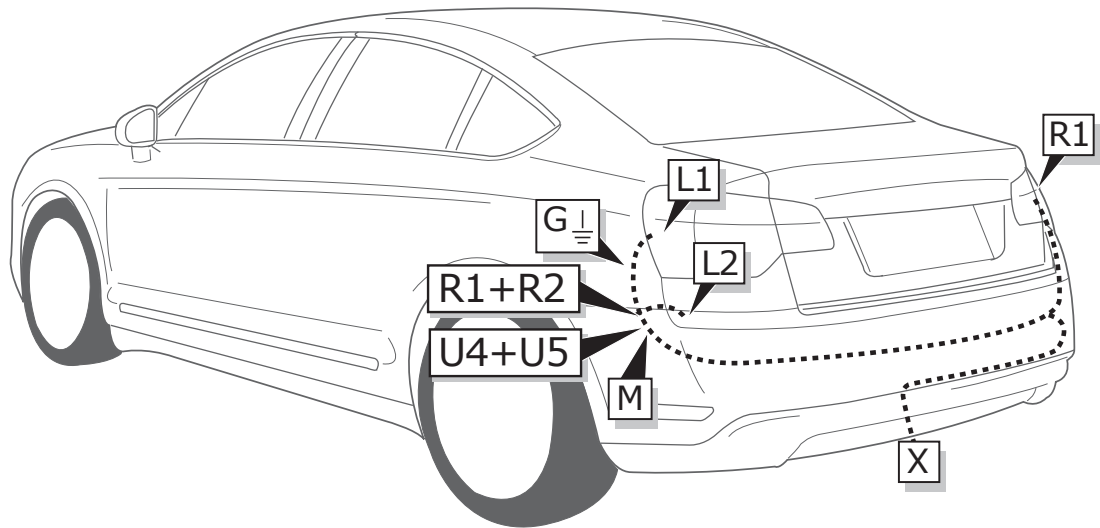

1

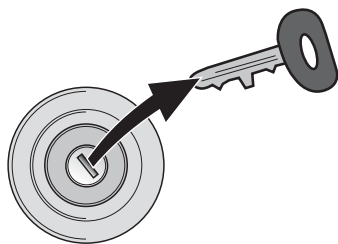

1

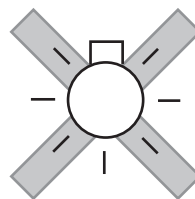

2

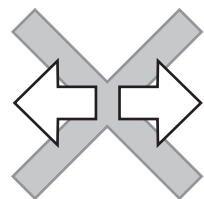

2

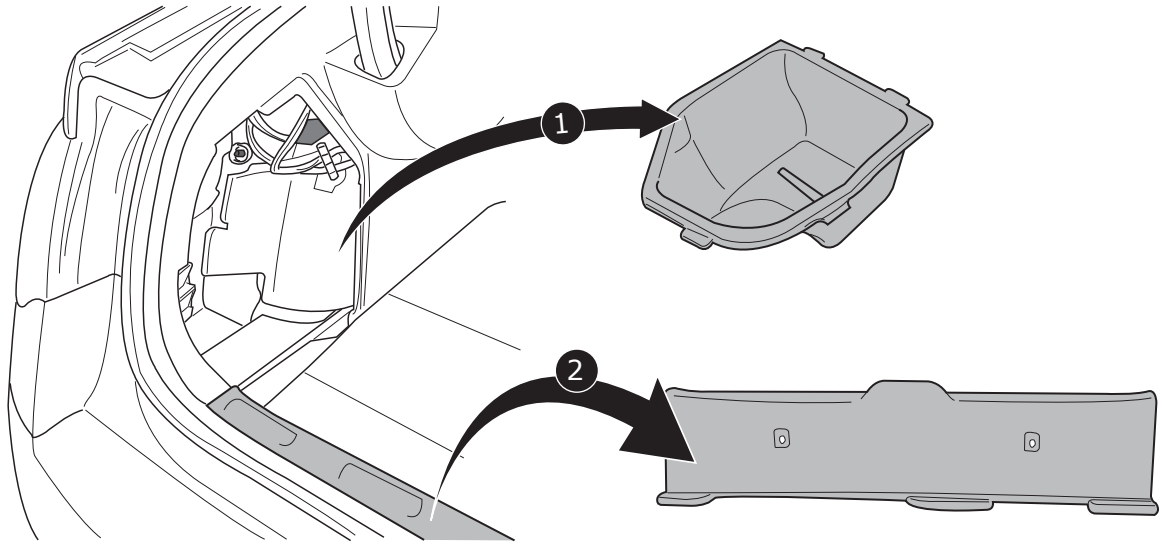

3

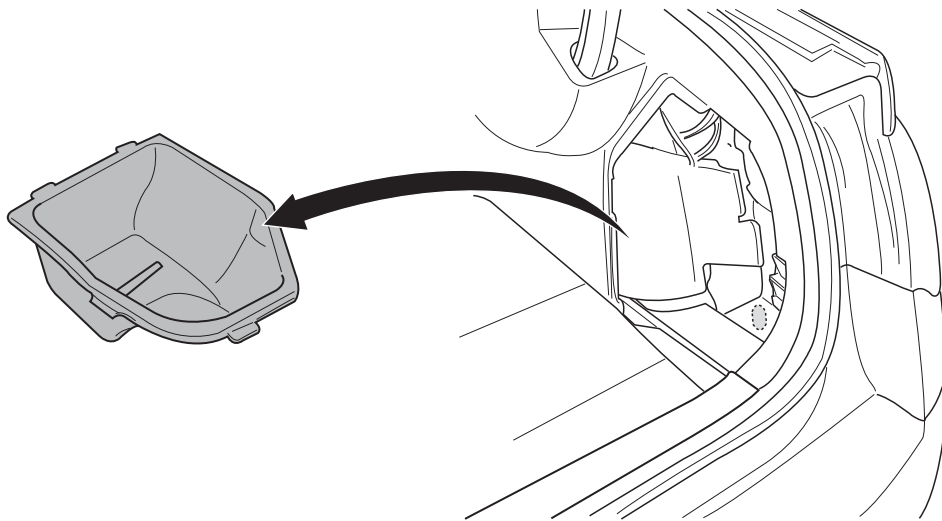

4

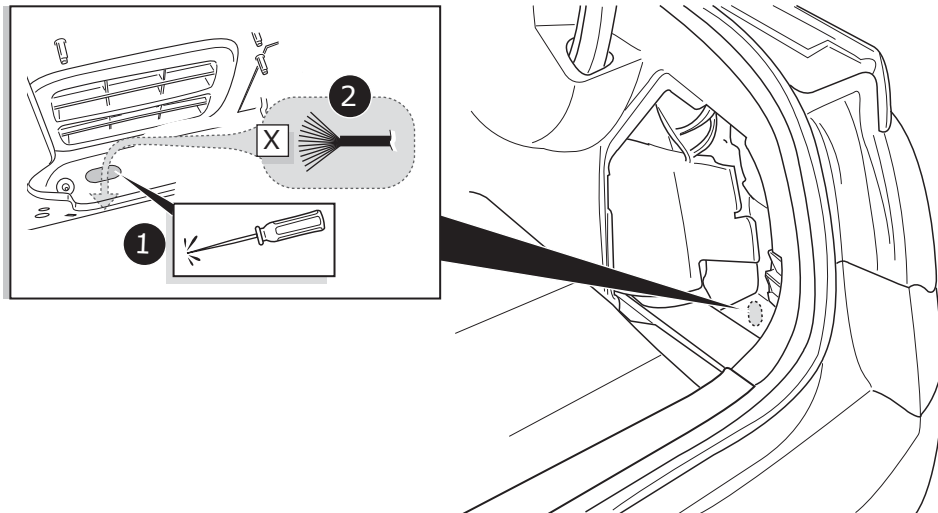

A

Option 1

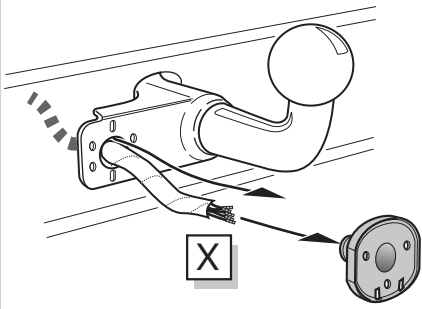

Option 2

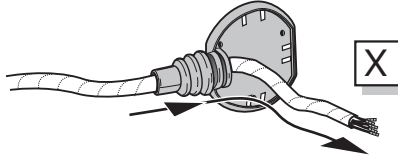

Option 3

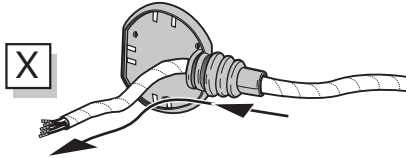
**INFO**

SOCKET CONNECTION



Pag. 10

B

Option 1

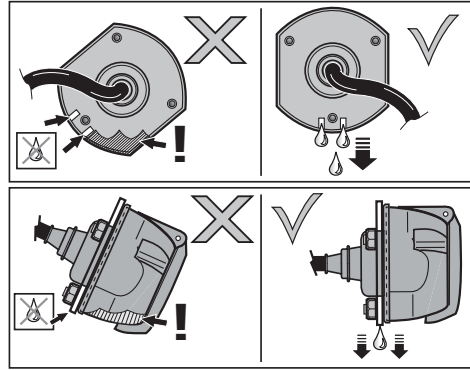
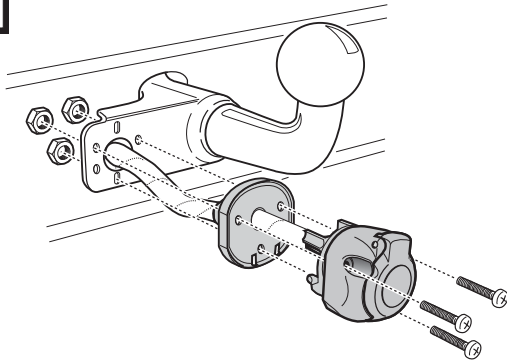
**C**

Option 2

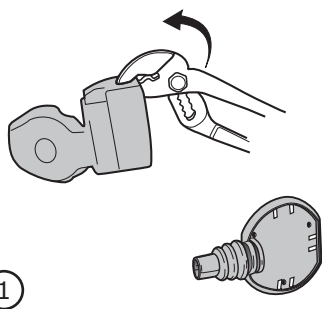

①

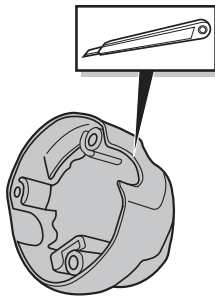

②

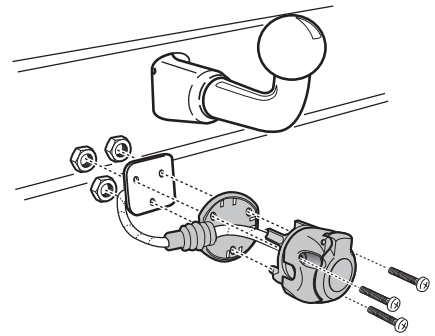
**D**

Option 3

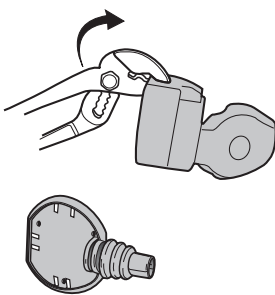

①

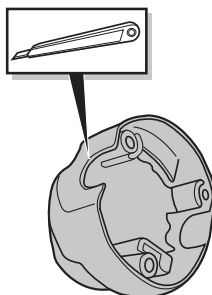

②

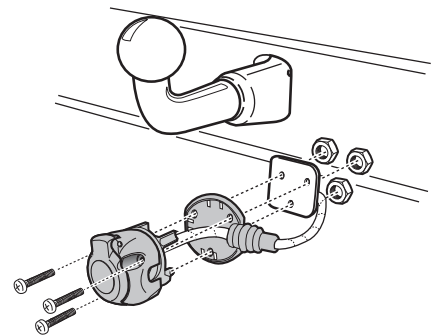

③

5

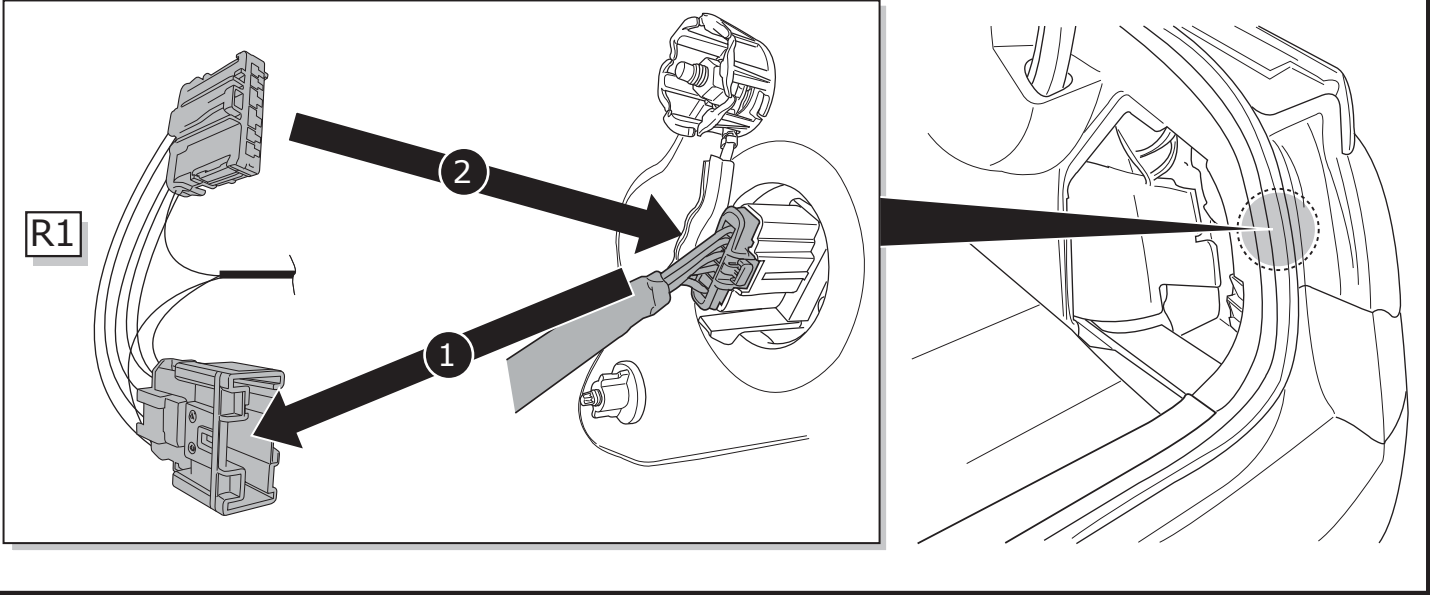

6

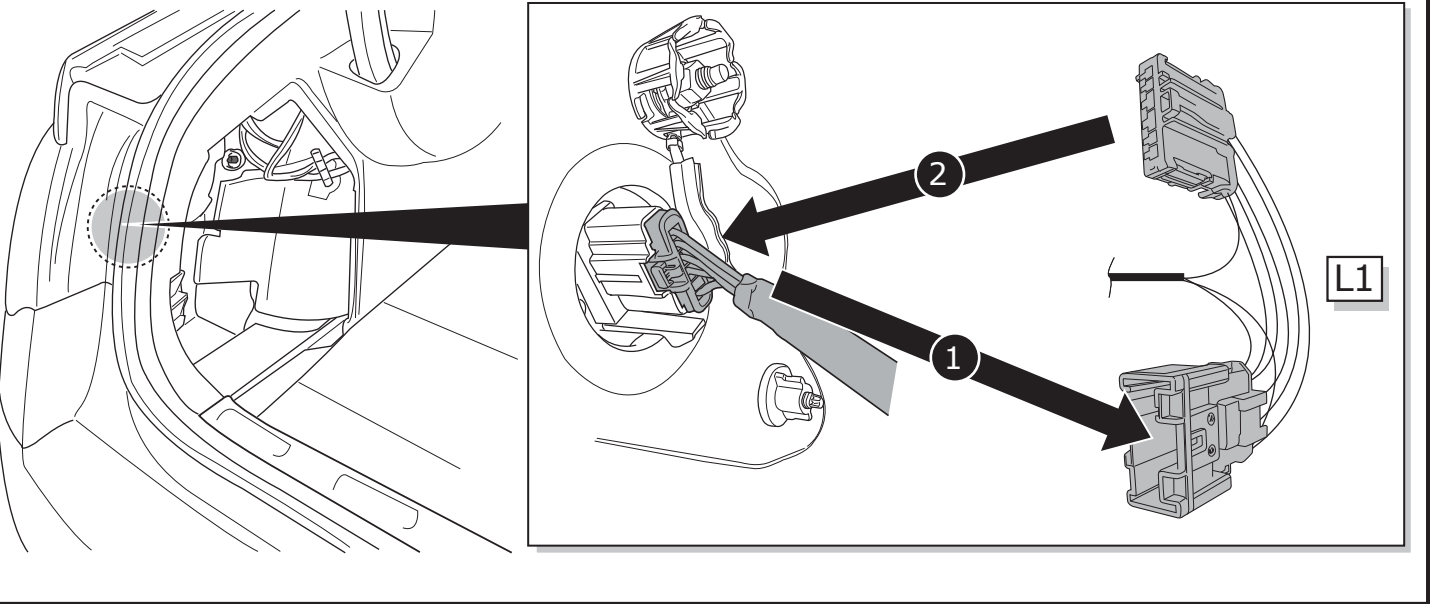

OPTION

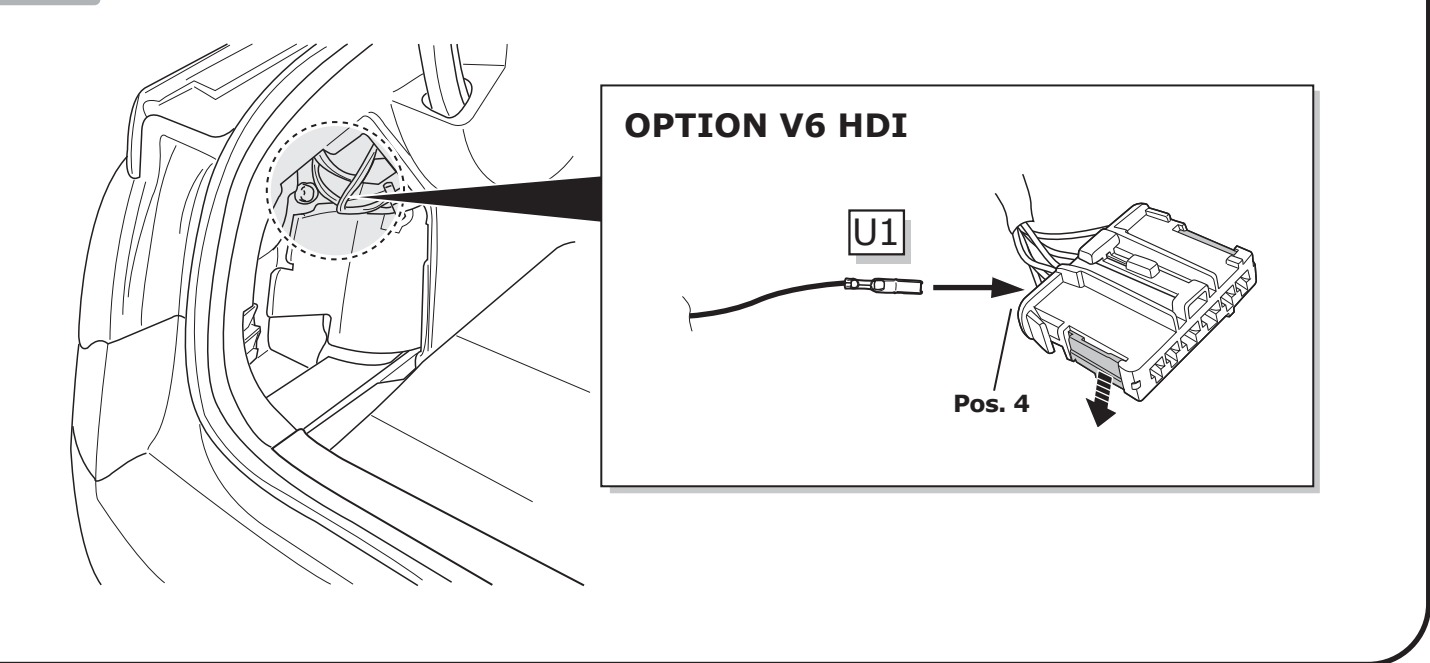

7

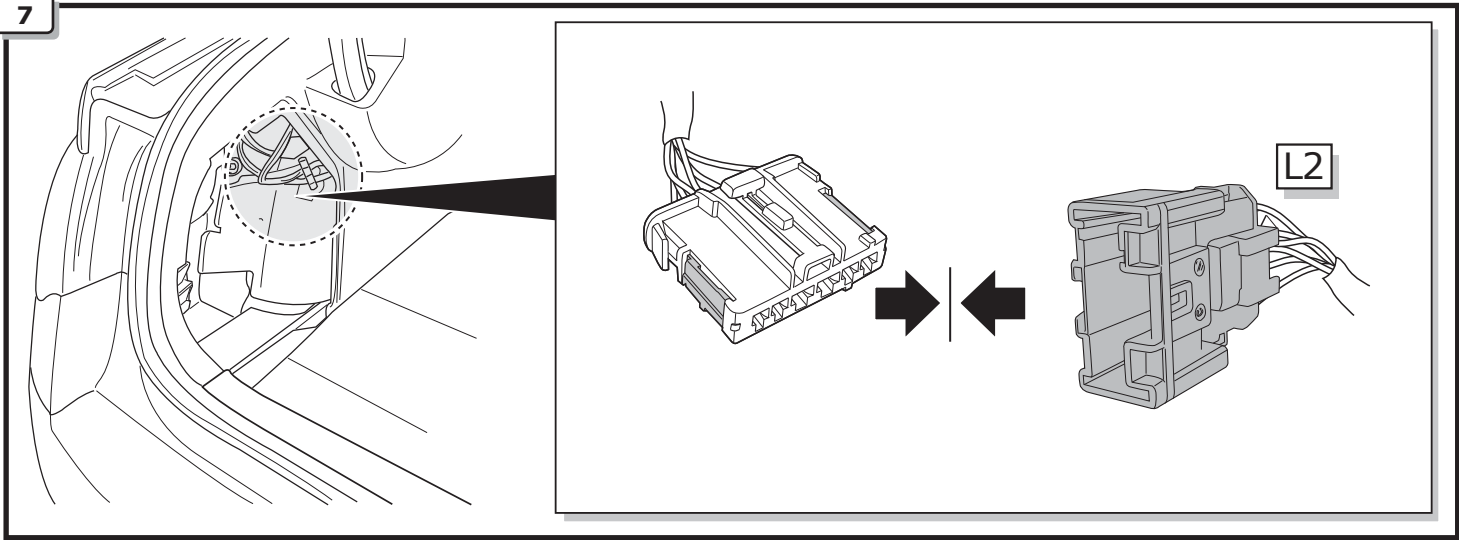

8

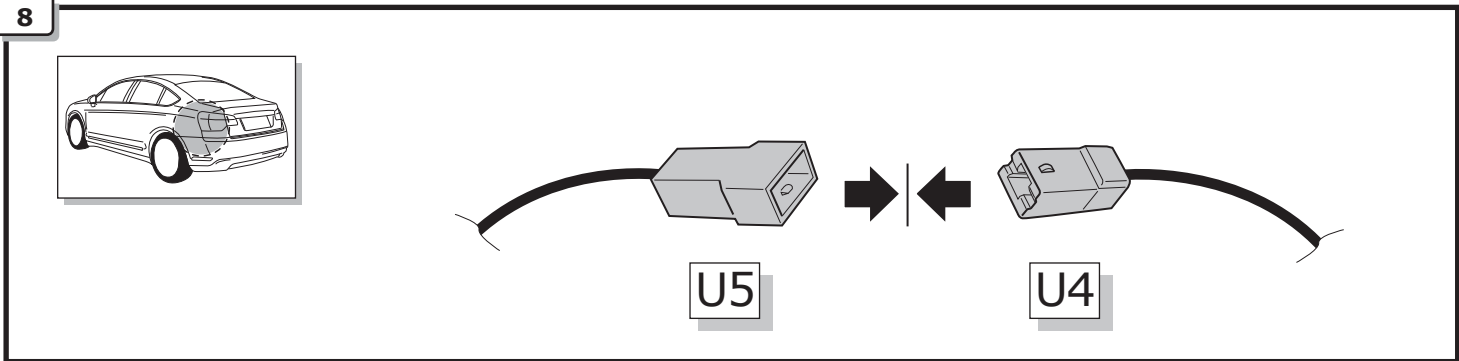

9

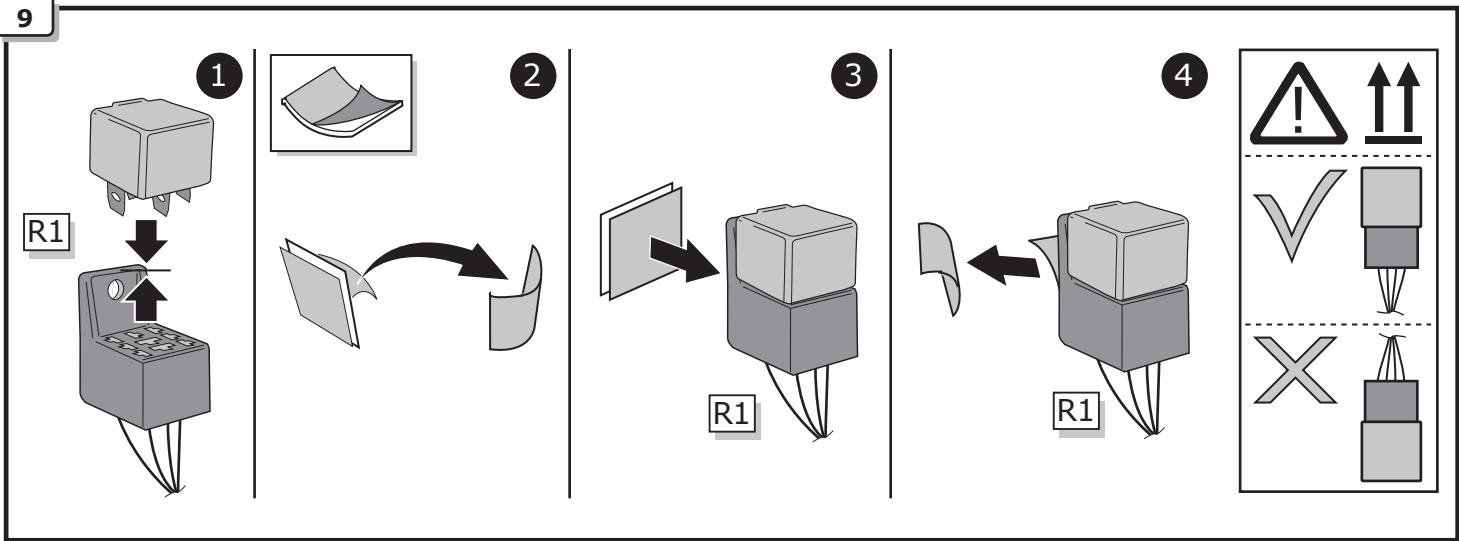

10

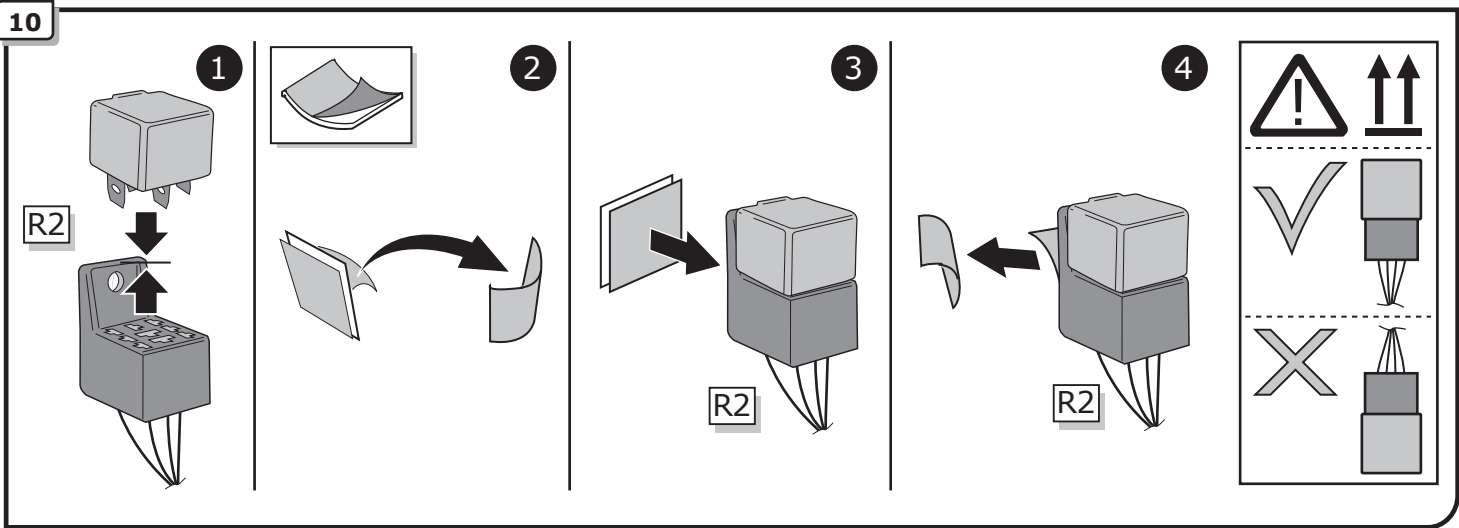

11

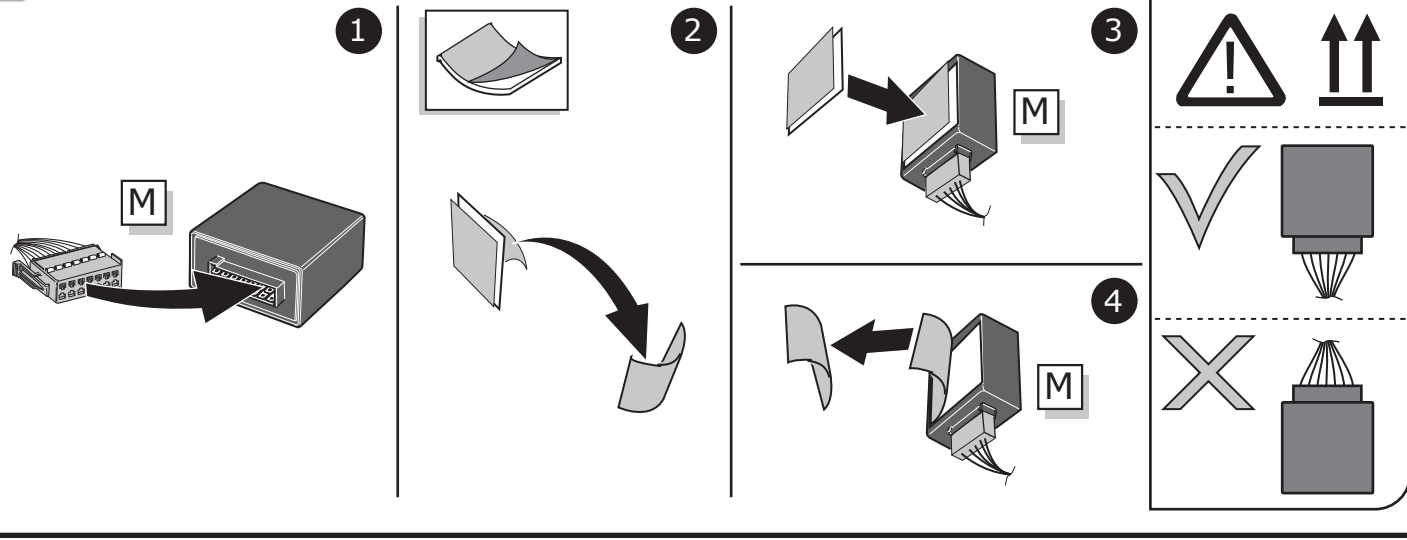

12

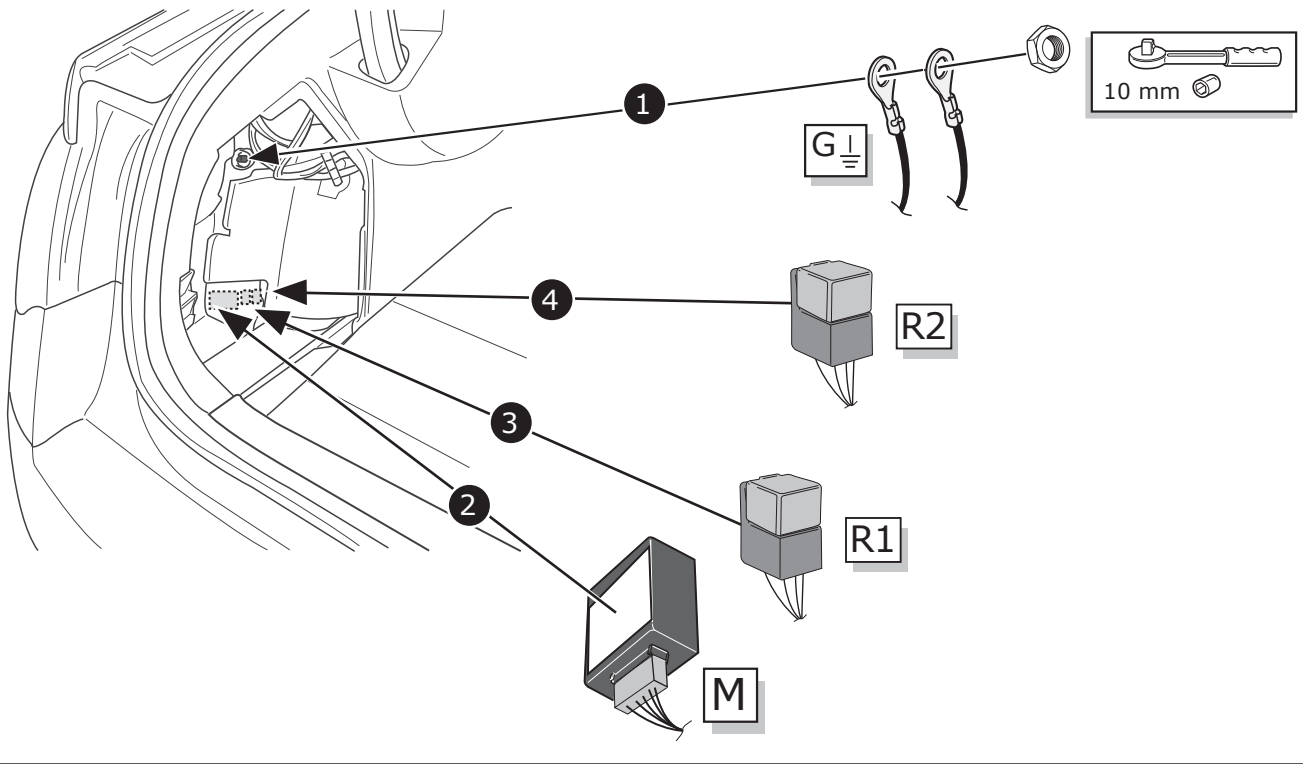

INFO

OPTION V6 HDI

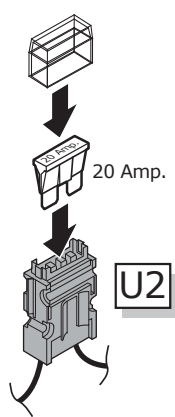

OPTION V6 HDI

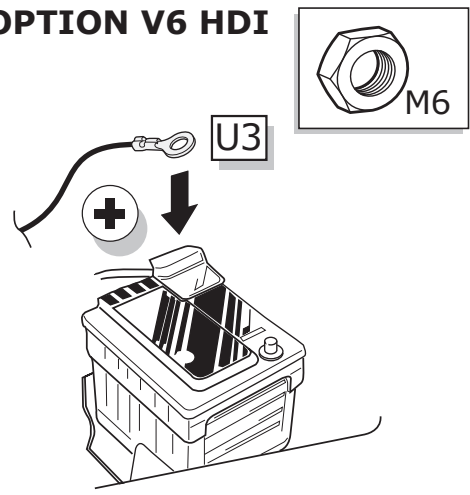

TEST ALL THE CIRCUITS WITH A TEST DEVICE WITH THE CORRECT POWER LOAD FOR EACH FUNCTION. A TEST DEVICE WITH LED'S CANNOT BE USED FOR THIS PURPOSE.

INFO

REINSTALL TRIM.



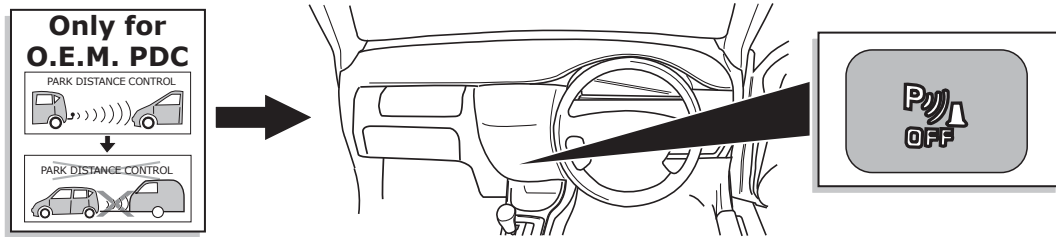

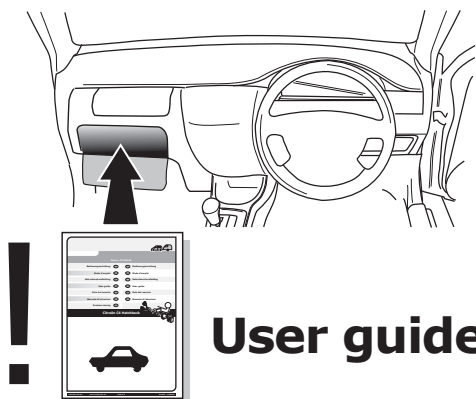
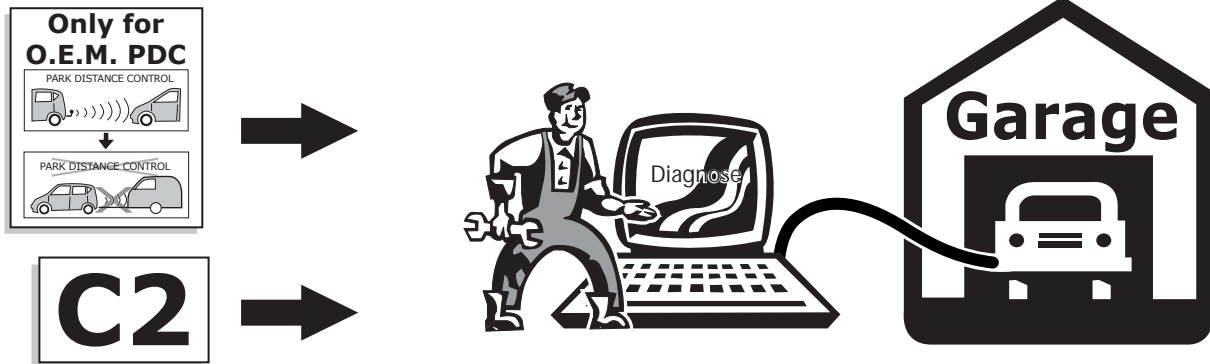

INFO



INFO



SOCKET CONNECTION

DIN/ISO 1724			 1-7				
	1/L	2	3/31	4/R	5/58-R	6/54	7/58-L
Pmax	21W	2x21W		21W	52W	3x21W	52W
Colour	Yellow	Blue	White	Green	Brown	Red	Black

UN-243-YZ Reverse lamp pre-wire extension

⚠ MAX = 21W

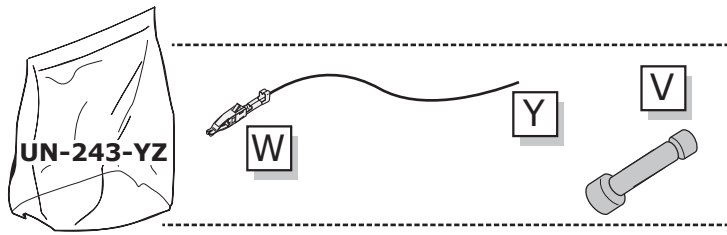

A

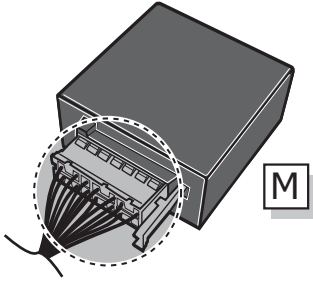

1

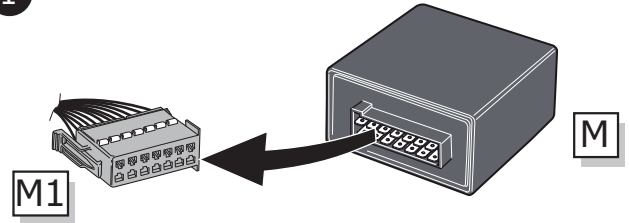

2

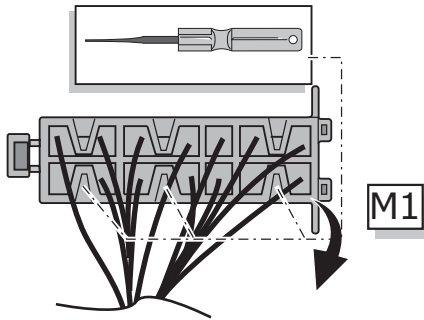

3

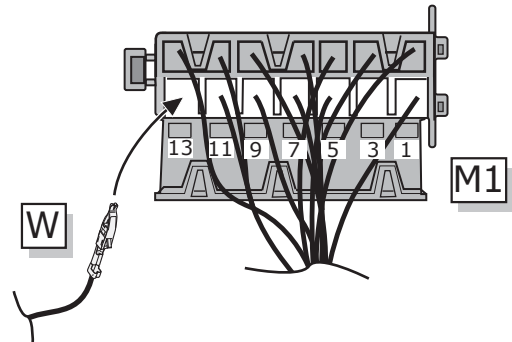

4

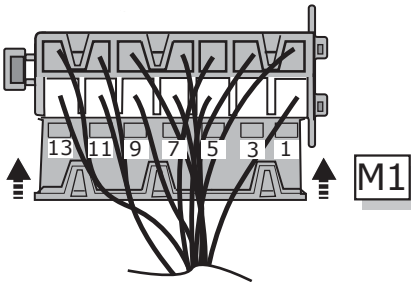

5

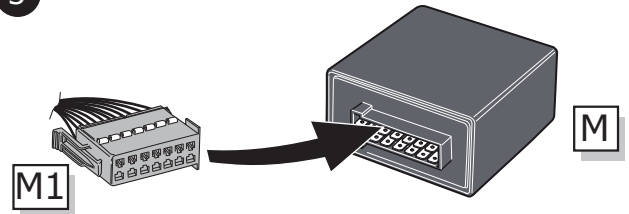

B

⚠ MAX = 21W

